

INSTALLATION MANUAL

for the Application iHC-MAIRF CLOUD



▶ Google play

iNELS[®]

Contents

1.	Introduction	3
2.	Installing the application on a smartphone with OS Android via the service Google Play	4
3.	Installing the application on a smartphone with OS Android	5
4.	The initial launch of the application - Setup Guide	6
4.1	eLAN	7
4.2	Rooms	9
4.3	Units	10
4.4	Scenes	11
4.5	Widgets	12
4.6	Cloud	13
4.7	Cameras	14
4.8	Intercom	15
5.	Application Menu	16
5.1	Products	17
5.2	Settings	18
5.2.1	eLAN settings	19
5.2.2	Units	21
5.2.3	Rooms	24
5.2.4	Scenes	25
5.2.5	Widgets	26
5.2.6	Advanced settings	27
5.3	Help	36
5.4	Log out	36
6.	Control	37
6.1	Rooms	38
6.1.1	Controlling dimmers	39
6.1.2	Controlling switches	40
6.1.3	Temperature control components	44
6.1.4	Display of energy measurements	47
6.2	Scenes	49
6.3	Weather	50
6.4	Cameras	51
6.5	Intercom	51

1. Introduction

The applications iHC-MAIRF CLOUD (for mobile phones with OS Android) are designed for comfortable control of the RF Control electrical installation using your mobile telephone. This is an RF Control system accessory, and as a part of the iNELS Smart Home Solution, its elegance blends in with any modern home. The menu is divided into clearly structured sections in which the icons indicate individual functions. Here you will also find faster access to your favourite functions, and you will maintain a constant clear view of what's happening in and around your home.

Thanks to iHC-MAIRF CLOUD (the „application“), you can perfectly control the function of your wireless RF Control electrical installation. You thus keep complete control over your home lights, appliance switching and heating.

The application only works with the devices eLAN-RF-003, eLAN-RF-Wi-003 RF control components or eLAN-IR-003 to control A / V equipment. One of the components must be used in your wireless installation.

- It is designed for devices with OS Android 5.0 and higher.
- It is optimized for devices with a display resolution of 800x480
- The application language follows the language set in the OS Android

You can create a Cloud Account using the Setup Wizard or log in Button in the main menu. The recommended minimum speed for connecting the eLAN-RF to the cloud is expected to be in the hundreds of megabytes per second (3G - 1Mbit / s or higher).

Implemented communication with Axis video cameras, thanks to which you can monitor what's going on around your home.

It also enables control for multiple users at once

It allows the control of several smart boxes at once.

It allows you to control up to 6 eLAN boxes.

Allows weekly programming, of RF components and heating / cooling circuits.

Note: If heating is by a combination of different heat sources (e.g. fireplace and electric boiler), it is necessary to solve the inter-connection during the installation. This is because the inertia thermo-heads functions are not adapted to the sudden high temperature variations, which occur during rapid heating of water e.g. the fireplace. When combining heating with a fireplace, it is advisable to have at least one heating component in the heating system fully open.

The options for a single eLAN

max. number of actuators - 40 (maximum of 70 (Not counting the heating cooling circuits)

- max.number of timetables for actuators - 10
- max.number of time schedules, heating / cooling - 16
- max.number of actuators in one schedule – 10
- max.number of intervals in one schedule - 8
- max.number of heating / cooling circuits - 16
- max.number of actors in the heating / cooling system - 10
- max.number of central sources - 4
- max.number of circuits on a single a central source - 16

Downloading::

Download the current version at Google Play (under the name iHC-MAIRF CLOUD).

https://play.google.com/store/apps/details?id=cz.elkoep.ihc_mairf_cloud

2. Installing the application on a smartphone with OS Android via the service Google Play

- Connect to the Internet using your mobile telephone.
- Activate the service **Google Play**.
- In the search bar, enter the password **iNELS** and press Search.
- Select the application **iNELS Home Control RF Mobile - Cloud** from the list and open the dialog field with information on this application.
- Press the button *Install*. A message is displayed on permission to access the telephone services. These services are a condition for installing the application - press *Accept*.
- On the display, a downloading bar graph appears indicating that the application is downloading to the phone, followed by an installation notice.
- After installing the application in the phone, the buttons *Open* and *Uninstall* appear.
- Press the tab in the icon *Application*.

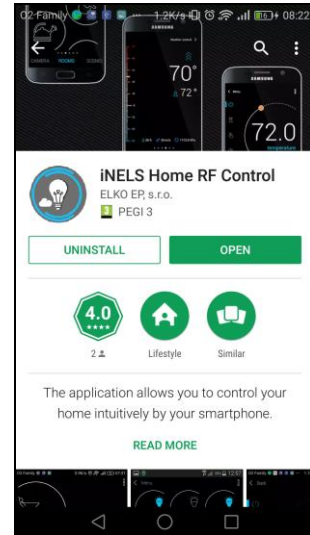
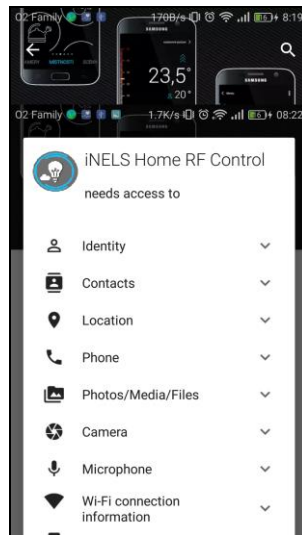
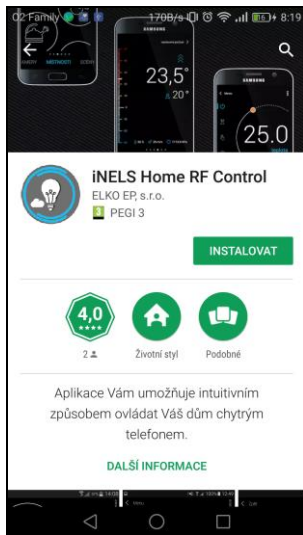

3. Installing the application on a smartphone with OS Android

- You can also install the application in your smartphone from a file. The application can be downloaded to the PC or the telephone into the given file system.
- Using your smartphone and the tool *File manager*, search for the stored application iHC-MAIRF CLOUD in the file system directory.
- Press the file with the application **iHC-MAIRF CLOUD.apk** to start installing the application..
- The OS asks you for access to provided services needed for the application to run. Press the *Install* button to start the installation.
- After completing the installation, the OS informs you of successful completion of the installation. By pressing *Open*, you can verify the installed application iHC-MAIRF CLOUD straight away.

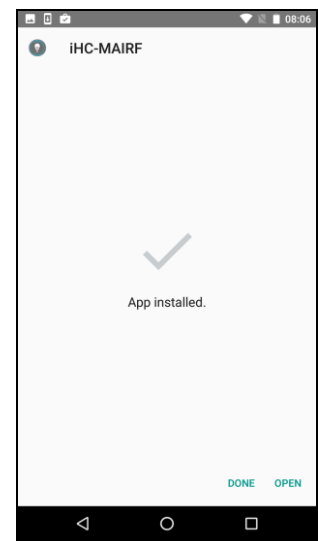
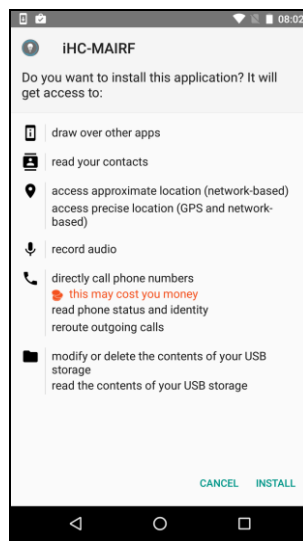
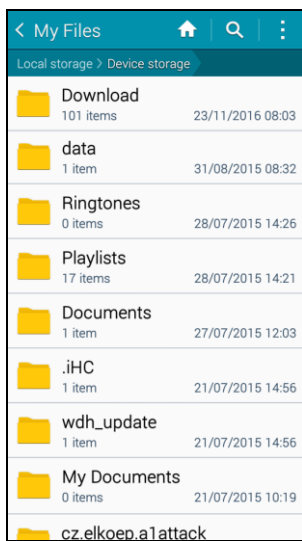

- After installing, the icon will appear on your mobile device:



4. The initial launch of the application - Setup Guide

When you first activate, the application menu will appear directly, run an application or try the PROMO version.

To run the PROMO version press *Demo*.

After pressing the Guide displays the **Setup Wizard**, which shows you the options settings.

If you do not want the application to set any components press *Skip* to access the application directly.

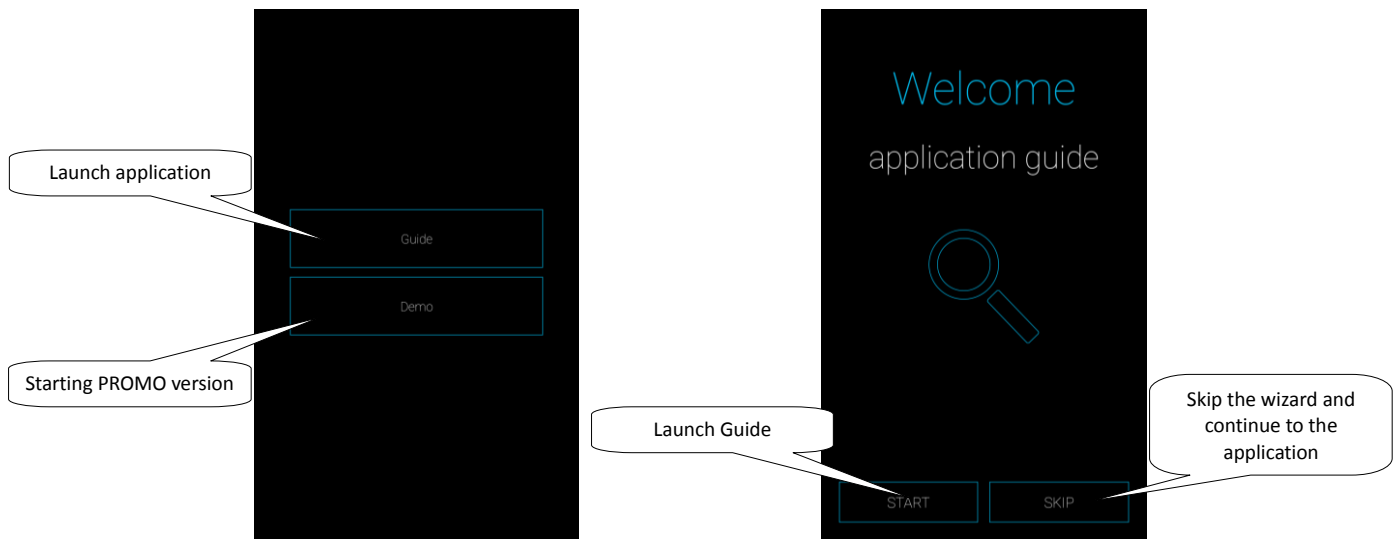

4.1 eLAN

Used for adding new devices eLAN-RF-003, RF-eLAN-Wi-003 or eLAN-IR-003 (hereinafter referred to as "eLAN"), its removal, activation or deactivation.

eLAN may add manually, or by the automatic search.

Before scanning, make sure that you are connected to the same Wi-Fi network, which your eLAN is also connected.

- **Manually adding:** If you know the IP address eLAN to which you want to connect, Press Manual. Enter the (arbitrary) name, IP address and port (default setting) and login (default name: admin password: elkoep or username: user password: elkoep).

List of usable ports:

Port	Protocol	Description
8080	TCP	Connection Server - access to web-interface
8081	TCP	Connection Server - access to update server web-interface
9000	TCP	Connection Server - access to web-interface of LMS Audio zone and Audio player GUI
9001	TCP	Connection Server - access to daemon supervisor web-interface overview (daemon maintenace and logging)
8090	TCP	iMM Client - access to web-interface client part
61695	TCP	LARA - access to web-interface / remote control for third-party devices and applications
62000	TCP	LARA - access to port related to DLNA server. It is based on UPnP to stream audio content.
80	TCP	eLANRS485-232 - access to web-interface
8000	TCP	iHC applications - access to encrypted communication between applications and Connection Server / iMM server
9999	UDP	iHC applications - access to communication between applications and central unit CU3
61682	UDP	iHC applications - access to communication between applications and central unit CU2
9999	UDP	iHC applications - access to communication between applications and RFPM-2M
80	TCP	eLAN RF - access to web-interface
8001	TCP	iHC applications - access to unencrypted communication between applications and Connection Server / iMM server

More detailed description of the port use:

https://en.wikipedia.org/wiki/List_of_TCP_and_UDP_port_numbers

- **Automatic search:** Press Auto. The eLAN found appears, which is located in your network that you are currently connected to by phone (home network). Amongst the retrieved eLANs touch the grey dot to activate the desired eLAN (max. 6). Once you have clicked on the IP of the eLAN you have to enter the login information (default name: admin password: elkoep or name: user password: elkoep). You will get the opportunity to download data from the eLAN to the application (without this data, applications may not work correctly).

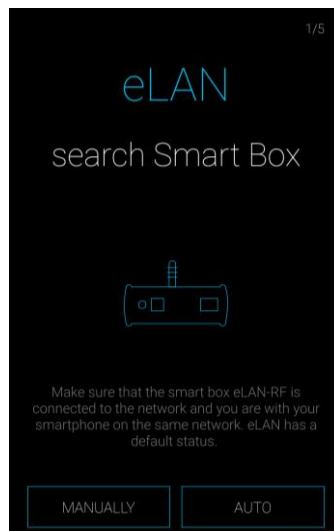

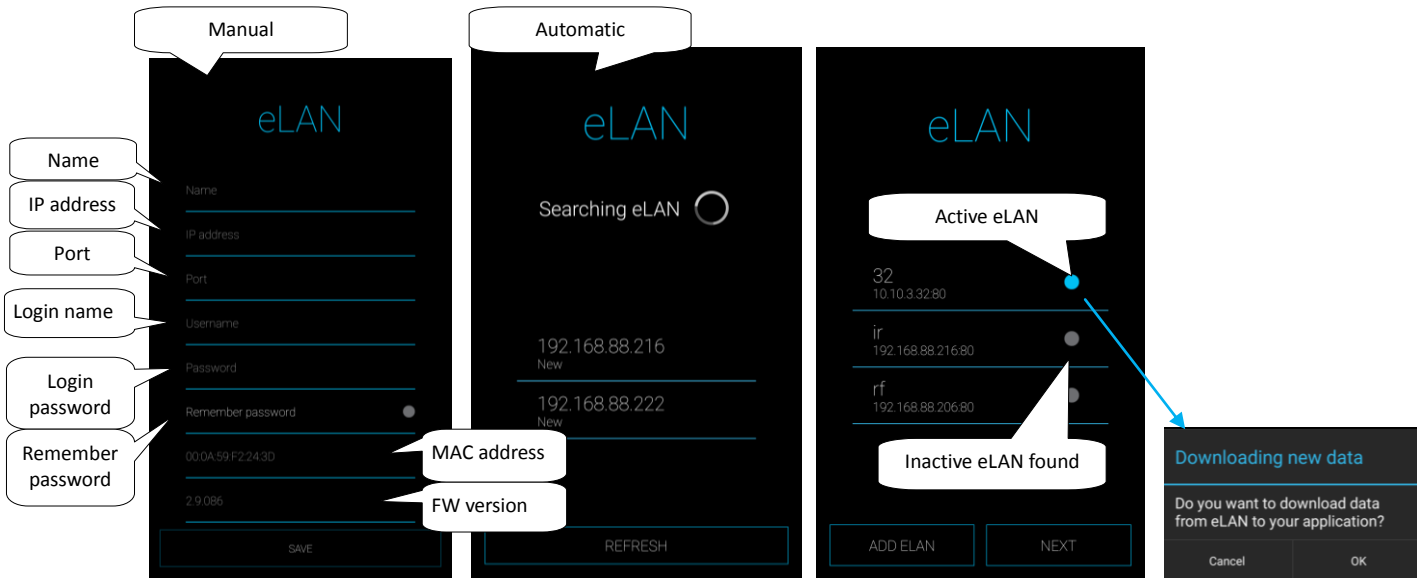

Note: Here you can introduce one eLAN even with two IP addresses (with an internal IP address for the home network and a public IP address for remote communication).
With an administrator account you can interact with the eLAN configuration. With a user account you can only control the created configuration.

4.2 Rooms

Settings for **eLAN-RF-003** and **eLAN-RF-Wi-003** (hereinafter referred to as "eLAN-RF").

For better clarity, create a room that is assigned to each eLAN-RF, which you can then control. Components or detectors are then added to individual rooms. Press Next on the screen, a room can be skipped.

Pressing the *Add* button to enter the room setup menu:

- Name of the room - enter any name (with diacritics).
- Select eLAN - pressing on this field displays the IP address for the active eLAN-RF, where you can choose the desired eLAN-RF. Press the appropriate IP address to enter.
- Icon - pressing on this field displays the different types of icons offered. You select the icon you want by pressing it.

Save button to confirm the setting. Displays the room list you have created, with Add room button, you can continue to set up additional rooms.

To remove the room make a long press on the name of the room

Press *Next* to continue to the next application setup.

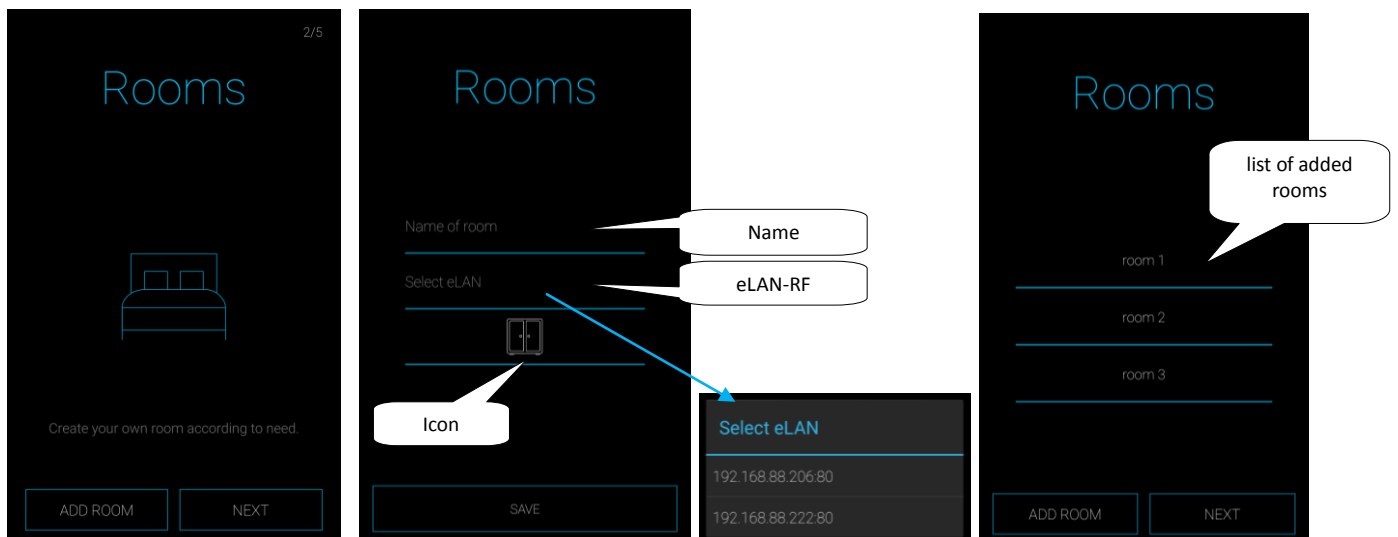

4.3 Units

The components must be assigned to individual rooms. Press Next to the **components** screen, you may skip this.

Press *Add components* to enter the settings menu:

- Name of unit - any component or detector name (with diacritics)
- Select eLAN - pressing on this field displays the IP address for the active eLAN-RF, where you can choose the desired eLAN-RF. Press the appropriate IP address to enter.
- Component Address - the address is a six-digit code listed on the unit box.
- Type of unit - select type of unit.
- Icon - pressing on this field displays the different types of icons offered. Press the icon you want to select.
- Room - from the list you can choose a room in which to save the component

Touch the *Save button* to confirm the setting. This displays a list of your created components. *Add components button*, you can continue to set other components.

Editing component - a short press of the name.

Remove component - long press on the name.

Press *Next* to continue to the next application setup.



4.4 Scenes

Scenes are used to control multiple predefined settings, such as: Everything turned on / off or All blinds up / down, etc. Press *Next* to on the screen **Scene**, you may skip this.

Pressing *Add scene* to enter the settings menu:

- Scene name - enter any name (with diacritics)
- Select eLAN - pressing on this field displays the IP address for the active eLAN-RF, where you can choose the desired eLAN-RF. Press the appropriate IP address to enter.
- Select features - touch to select a component (or detector), the function * that you set the scene as required. Pressing the *Back button* to return to the list of components, where you may continue to the next setting.

Note: A component that is already included in the heating circuit or used as a central source cannot be included in the scene.

Touch the *Save* button to confirm the setting. Displays a list of your created scenes. *Add scene button* you can continue setting other scenes.

Editing scenes - a short press of the name.

Removing scenes - long press on the name.

Press the *Next* button to continue to the next setup application.

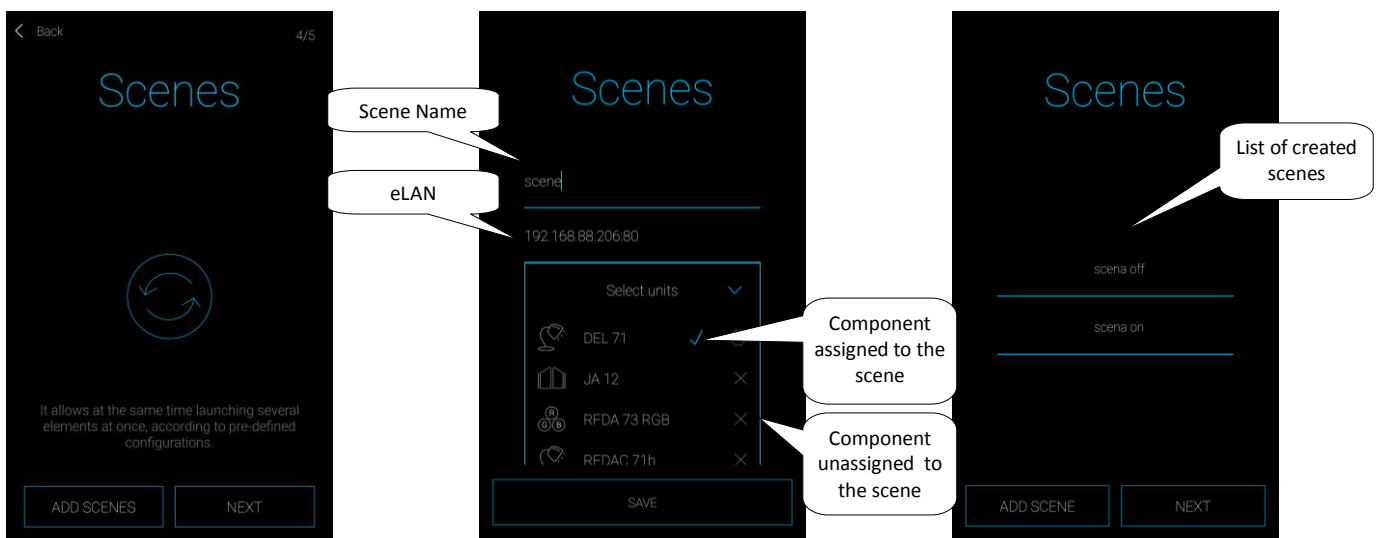

* function varies depending on the type of component (switching, dimming ...)

4.5 Widgets

Widgets, to view and control chosen components and scenes directly, on the home screen of your mobile phone.

Press *Next* to enter the **Widgets** screen, you may skip this.

Press the *Add widgets*, the widget box will appear: Components and scenes.

By pressing the arrow a menu appears with associated components (scenes). By touching mark the ones you want to appear as widgets.

Touch the *Save* button to confirm.

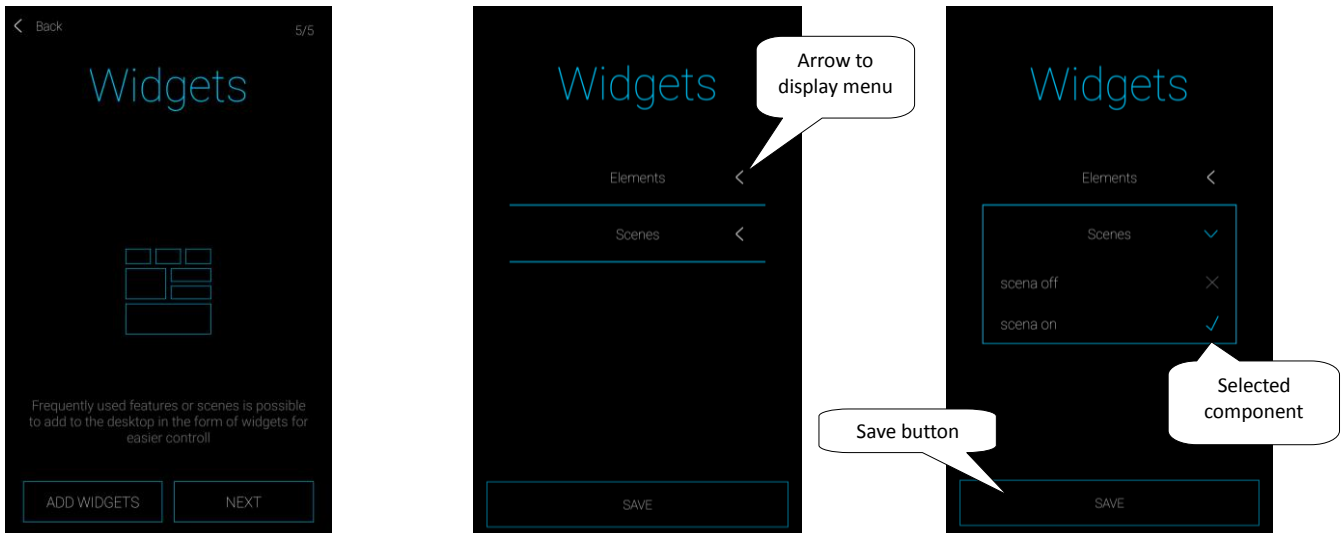

Note: Selected Widgets need to be activated on the main screen of your mobile phone. In the list of available widgets, find the Widget iHC-MAIRF CLOUD application. The Widget is brought to the home screen (the exact procedure may vary depending on the type of mobile phone).

A more detailed description of working with widgets is on page 23.

4.6 Cloud

The *LOG IN* button can create a new cloud account or log in to an existing one.

To create a new cloud account, you must register:

- Enter the email and *Create Account* into which you'll need to enter the registration token after you click Create Account
- Enter a password that contains at least one uppercase letter, number and special character: 0-9, [a-z], [A-Z], [!@#\$\$%^&*()_+\\-=\\|\\|{};:\'\"\\\|.,<.>\\|?]

When creating a new cloud account, you must confirm your agreement to the Terms of Service.

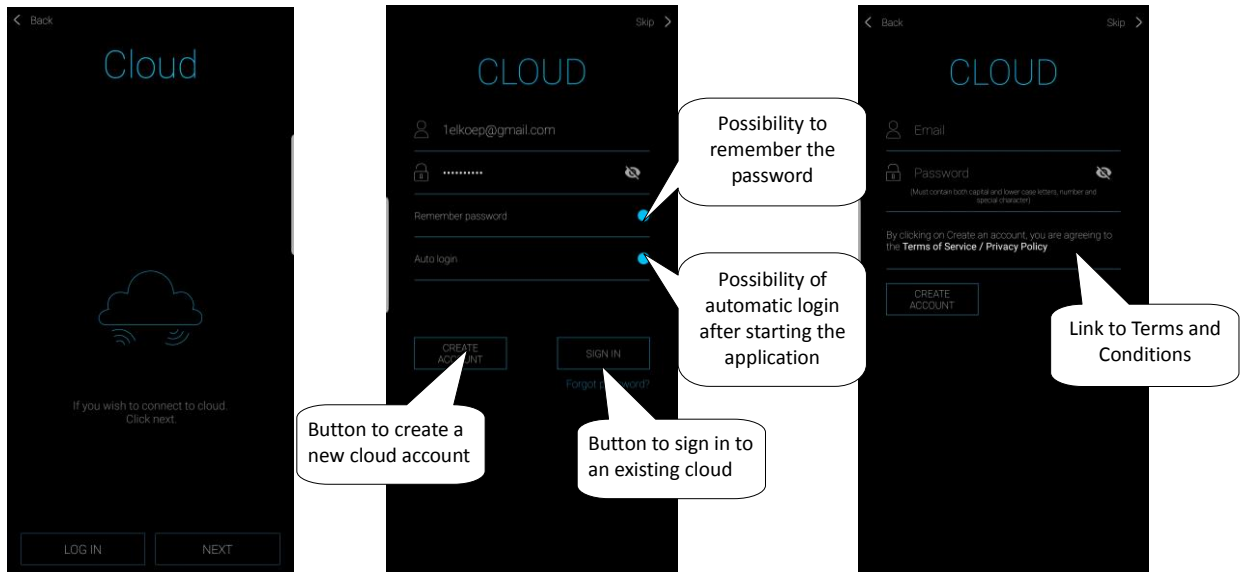

Warning: Registration emails can go to junk / spam mail folders, check for incoming emails in the junk / spam folders.

Password Recovery:

Clicking the *Forgotten Password* button will send the registration token to the specified email. Once the token has been entered into the application, the token resets the password and you can create new ones.

4.7 Cameras

Used for adding cameras. Press *Next* on the s camera screen, you can skip this.

Press the *Add cameras* button to enter the camera settings menu:

- Camera name - any name (with diacritics)
- Insert the camera address - Enter the IP address of the camera
- Camera type - from the menu select the type of camera from the settings
- Username - enter the username for access to camera
- Password - enter a password for access to the camera

Touch *Save* button to confirm the setting; Displays a list of added cameras. Use the *Add* button camera to continue to set other cameras.

Note: For more information, see chapter Cameras setups: Cameras, on page 24.

Camera Editing - Short press on the name.

Removing camera - long press on the name.

Press *Next* to continue to the next setup application.

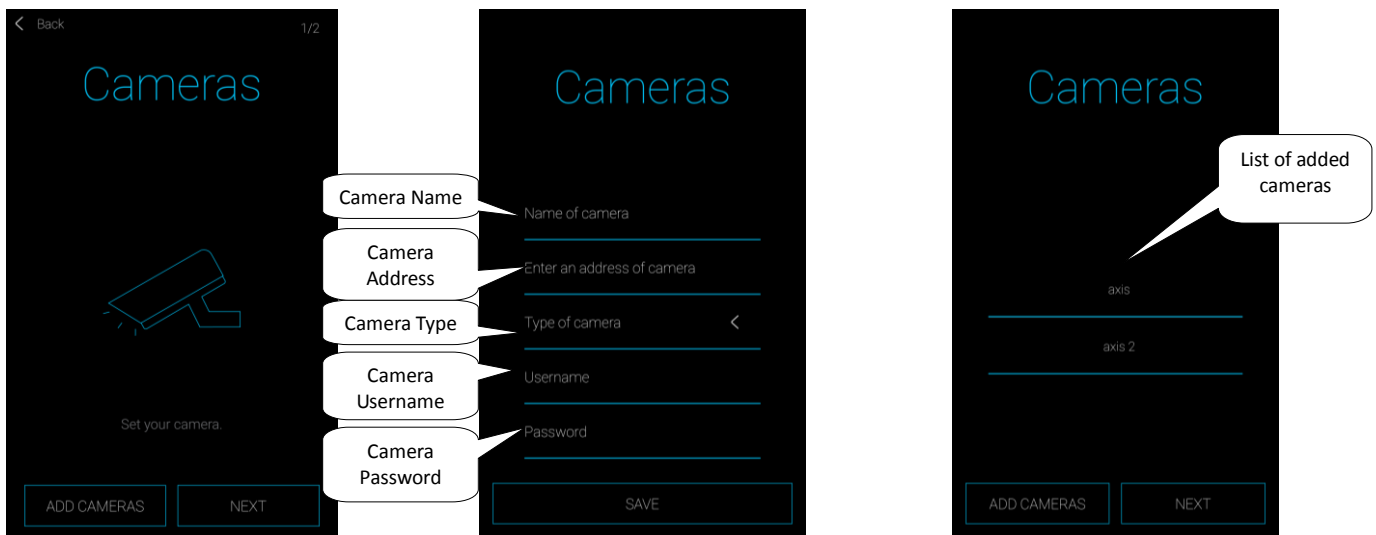

4.8 Intercom

Intercom allows data communication between the domestic audio units of 2N, Dahua, iHC applications and IMM applications (video zone). Communication is by voice; in case of camera images are also transmitted. Selecting the type of device (Intercom or Dahua) displays possible settings of the associated device types. Press the *Done* button on the **Intercom** screen, you can skip this.

Note: The web server interface Intercoms tab set: username, SIP username, password and video stream devices that beforehand have been arbitrarily chosen for the equipment (sound, applications, IMM client) and save it. In the case of using Dahua voice, this step is similar. First, you must create contacts on the relative server.

Press *Add* button to enter the intercom setup menu (Note: all contacts, voices and applications must be allocated on the IMM or Dahua server running Asterisk):

- Allow intercom - to activate the intercom
- **Select the type of equipment - Intercom**
- Name - the name of the SIP, the same as the IMM server
- Password - to the created SIP name
- Server address - the IP address of the IMM server or SIP server
- Contacts - press to download all contacts stored on the server (after downloading contacts, message confirming the successful download)
- Status - displays connection status (ON - connected, OFF - disconnected)

- **Select the type of device - Dahua**
- 2N SIP name - Dahua voice on SIP server
- 2N name - Username cameras
- 2N Password - The login password cameras
- Name - Name of contact registered on the server
- Password - A password registered to a contact on a server
- Server address - the IP address of the Dahua server
- Status - indicates connection status (ON - connected, OFF - disconnected)

Caution: The Dahua door-telephone configured without the connection server may not be compatible with all mobile phone models. We recommend that you use the Connection Server as a SIP server that handles the connection.

Press *Reset* to connect to the specified server. Press the *back* button to exit the changes and return to the Intercom menu.

You can edit the intercom by reopening the Intercom settings

Press *Done* to exit the wizard.

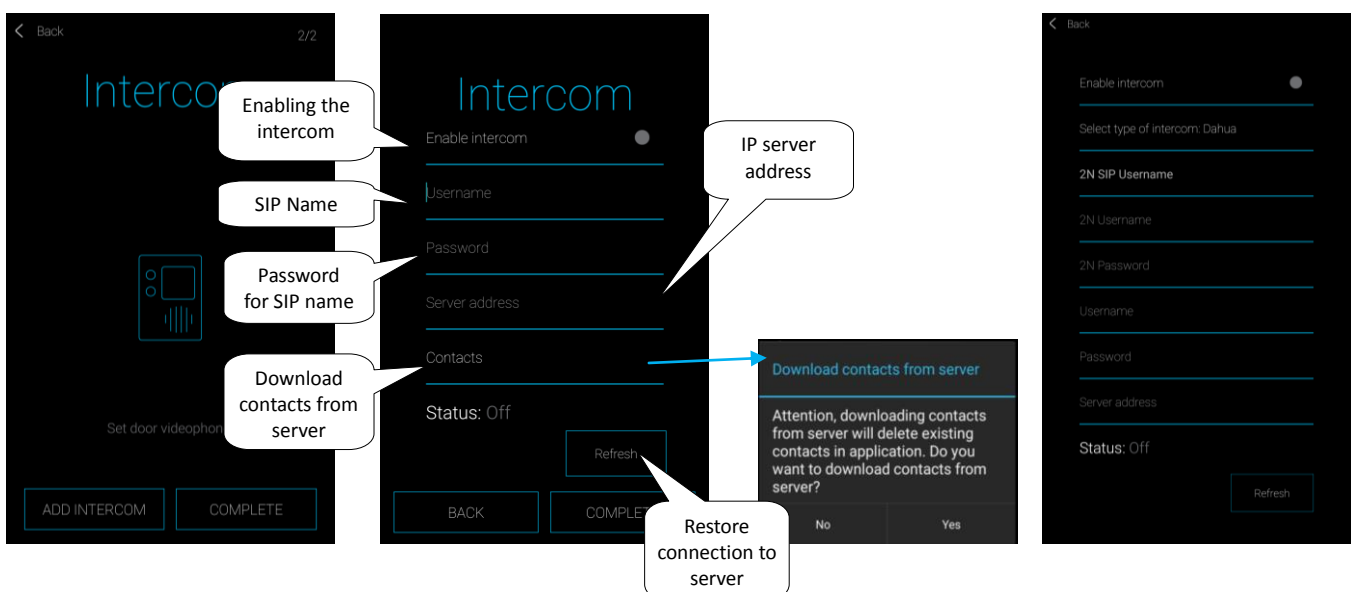

5. Application Menu

Welcome screen appears without first setting, using the Setup Wizard:

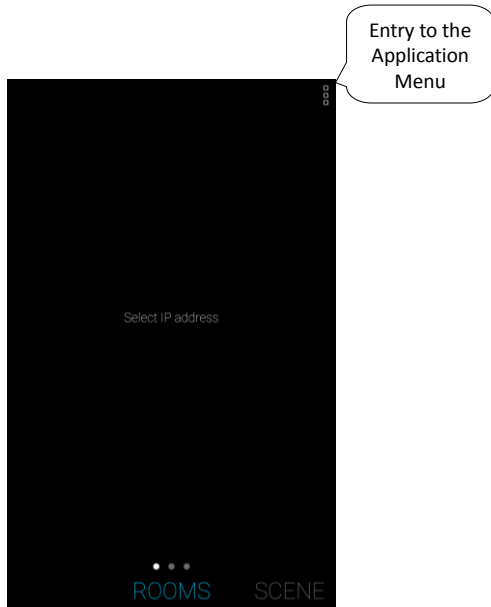

Welcome screen appears when you set up the rooms in the Setup Wizard:

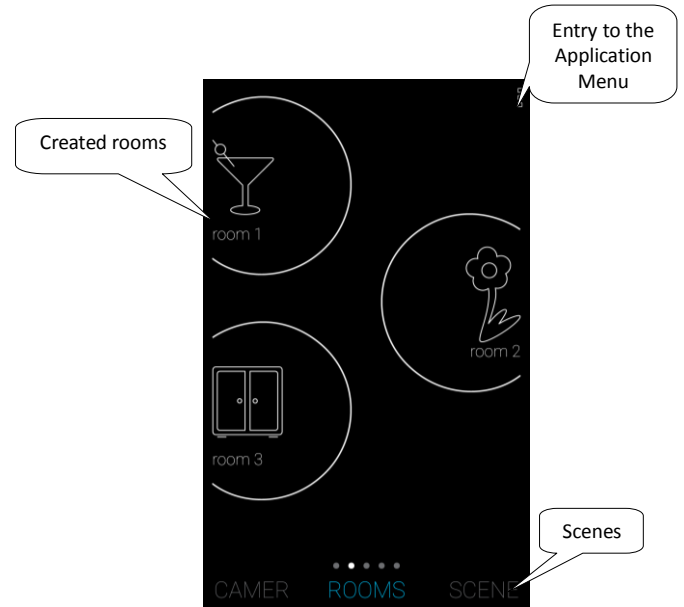

To view the application *Menu*, press the icon in the upper right corner. *Daily Menu*:

1. Products - access to the ELKO EP e-shop
2. Setting - application settings
3. Help – displays help menu
4. Login / Unsubscribe - logs in / out the application from a cloud account
5. Logout - logout from the application.

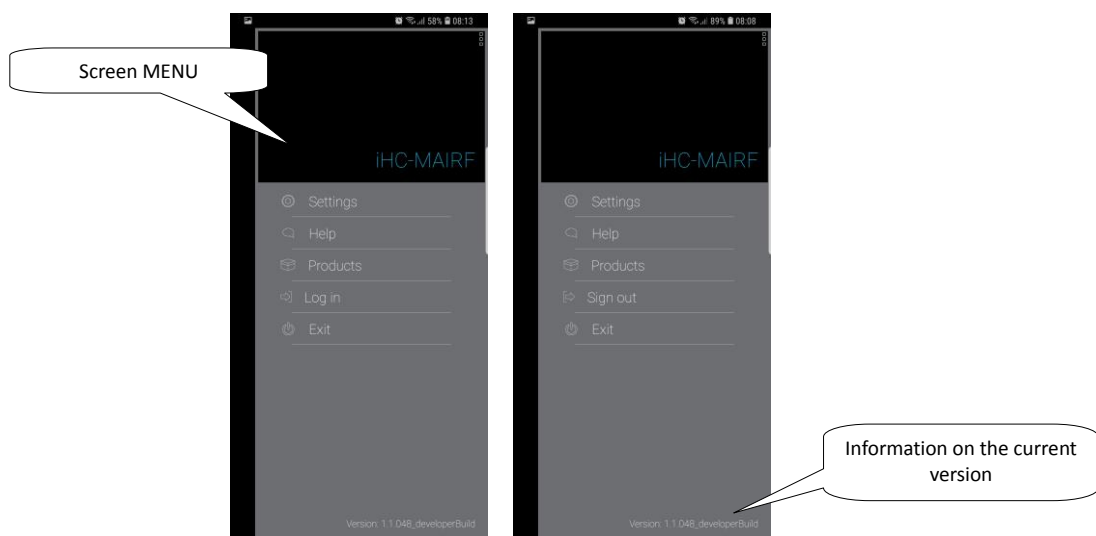

5.1 Products

After pressing the bookmark menu is displayed, products by category.

- **Drivers** - controls, for example. Key fob, remote control, wall control etc.
- **System components** - RF smart box, eLAN, touch unit, RF Touch, signal repeater, etc.
- **Dimmers** - universal dimmers or dimmers for LED strips and halogen, dimming socket.....
- **Switches** - Selection of switching components eg. For blinds or switch sockets
- **Temperature control** - temperature controllers, switching components with a temperature sensor or wireless thermal head
- **Lighting** - LED Strips, LED bulbs white and colour, power supplies and required twilight switches
- **Monitoring components** - flood detector and pulse transmitters for measuring energy
- **RF sets** - a combination of drivers and switching components or bulbs
- **Accessories** - cameras, weather stations, additional sensors and probes, external antenna and the like.

Touching on the various categories will redirect your web browser to the ELKO EP website.

Return to the application - touch the *Back button*.

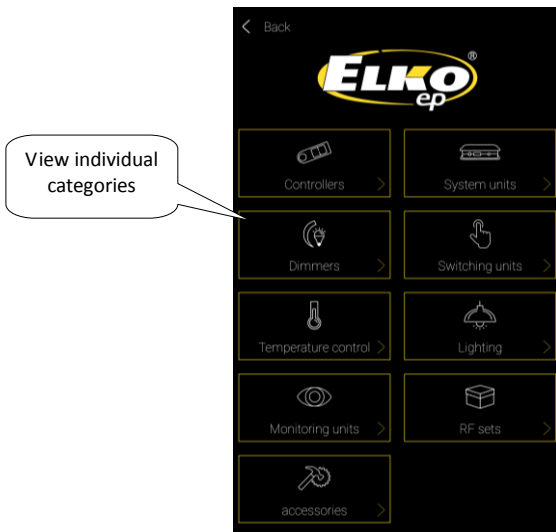

View individual categories

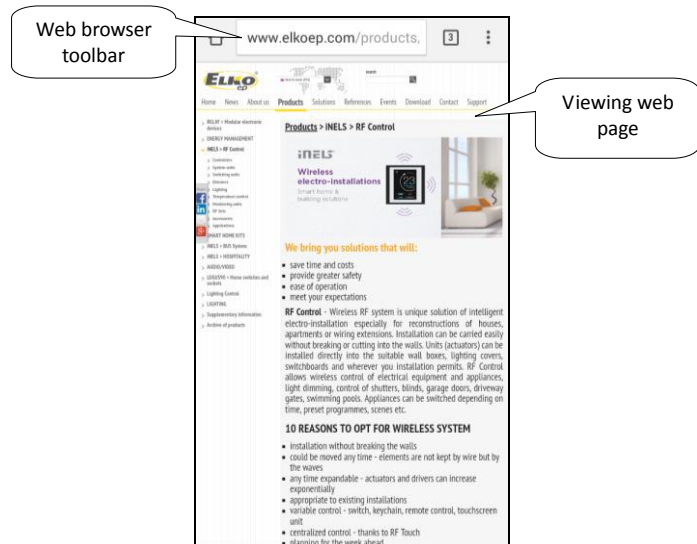

Web browser toolbar

Viewing web page

5.2 Settings

Press *tab* to enter the settings menu, where they will appear with the ability to modify and configure applications.

If you are not logged in to the Cloud, the Settings menu will appear:

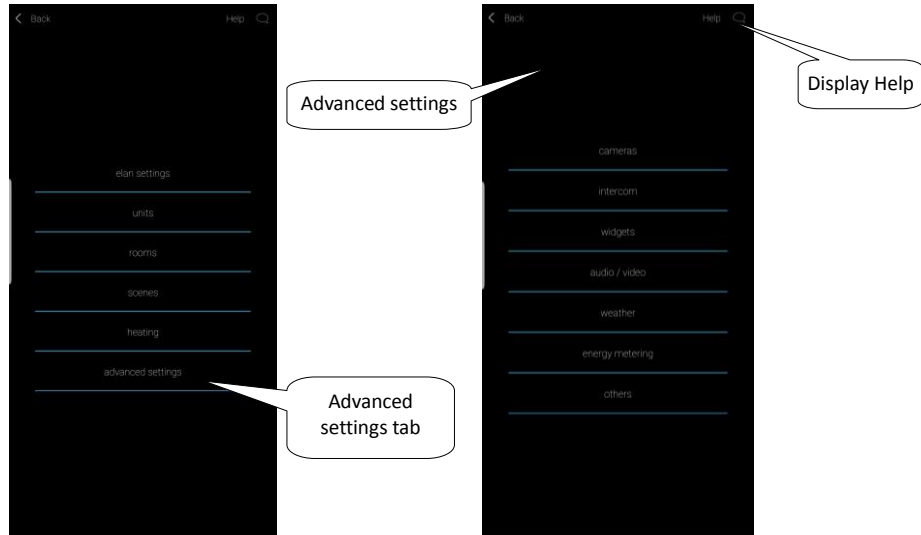

If you are logged in to the Cloud, the Settings menu will appear:

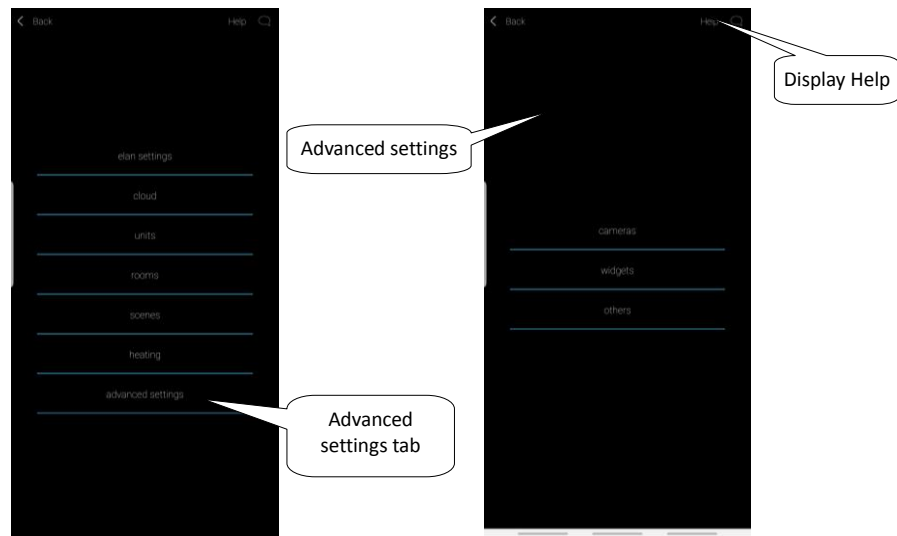

5.2.1 eLAN settings

Used for adding new devices eLAN-RF-003, eLAN-RF-Wi-003 or eLAN-IR-003 (hereinafter referred to as "eLAN"), its removal, activation or deactivation. eLAN may add manually, or by the automatic search.

Before scanning, make sure that you are connected to the same Wi-Fi network, which your eLAN is also connected to.

- **Manually adding:** If you know the IP address eLAN-RF to which you want to connect, Press the *Add* button. Enter the (arbitrary) name, IP address and port (default setting) and login (default name: admin password: elkoep or username: user password: elkoep).
- **Automatic search:** After pressing the *Search* button displays the eLANs found, which are located in your network. Touch the IP address to add the required eLAN to your list (you also enter a given eLAN name). Once you have clicked on the IP of the eLAN you have to enter the login information (default name: admin password: elkoep or name: user password: elkoep). Touch the grey dot to activate the desired New eLAN (max. 6).
Download button data, you can manually update the data of the selected eLAN. Data is automatically updated after exiting the eLAN settings menu.



Note: Here you can introduce one eLAN even with two IP addresses (with an internal IP address for the home network and a public IP address for remote communication). The application automatically checks the availability of eLANs. So if an eLAN is unavailable, it is not possible to download data from it and to control it. With an administrator account you can interact with the eLAN configuration. With a user account you can only control the created configuration

- **Log in eLAN to a cloud account:** Press the Configure cloud button to enter the cloud account created (the account is created using the wizard or log in button in the main menu) and the password. Save the data to eLAN, then the eLAN connects to the cloud. You can control it immediately after connecting it.
- One account can be assigned to multiple eLANs.

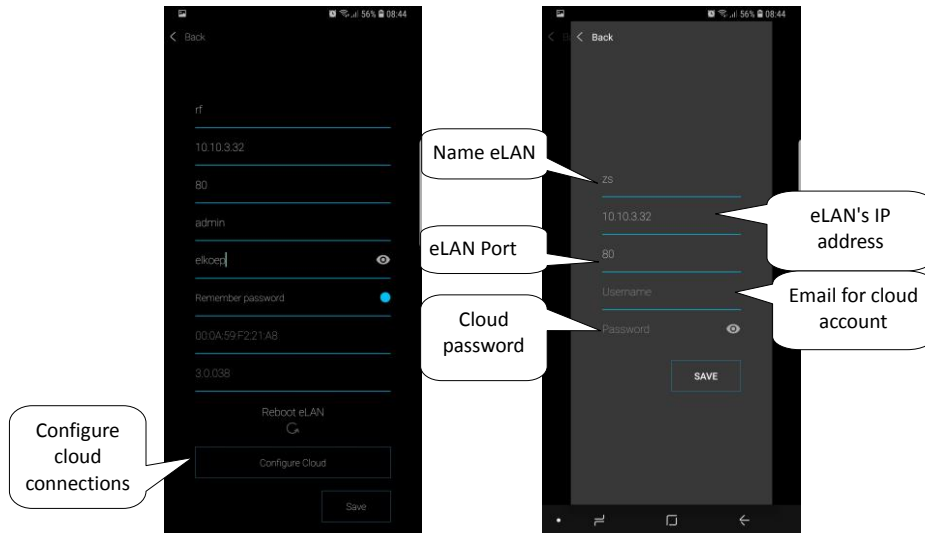

Return to the Settings menu - touch the *Back* button.

After successful connection to the Cloud Account, the Cloud menu will appear in the Settings menu, showing all linked eLANs with a signed-in account.

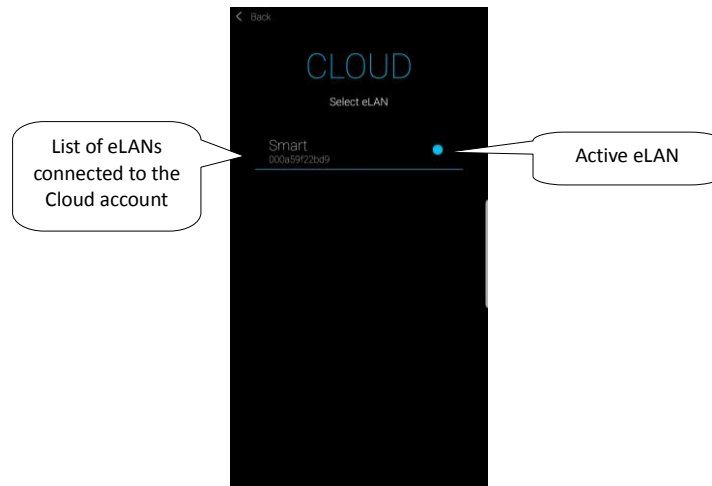

Notification of app connection to Cloud account (can be turned off in phone settings):

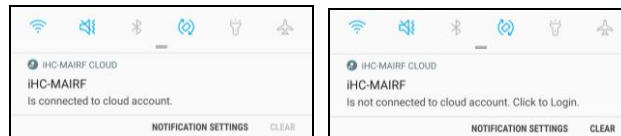

If a panel with information about unavailable eLAN is displayed, it is necessary to check the status of the eLAN connection locally, or configure the cloud again.

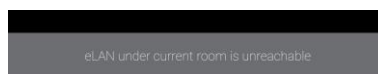

5.2.2 Units

Settings for **eLAN-RF-003** and **eLAN-RF-Wi-003** (hereinafter referred to as "eLAN-RF").
Used to add, edit or remove components and schedules.

Pressing the *Components* button, menu appears: Components a schedule. Touch the *Components* button to display a list of added features. Touching the *Add* button to enter the menu adding components:

- *Name of unit* - any name (with diacritics)
- Select eLAN - pressing on this field displays the IP address for the active eLAN-RF, where you can choose the desired eLAN-RF. Press the appropriate IP address to enter.
- Component Address- the address is a six-digit code listed on the unit box.
- *Type of unit** - select type of unit.
- Icon - pressing on this field displays the different types of icons offered. Press the icon you want to select it.
- Room - in the list you can choose a room in which to save the component

Press the *Save* button to confirm the setting. Return to the *Components / Schedule*.

Editing component** - on the list a short press of the name.

Remove component - in the component list by long press on the name.

Press the *Add* button in the list of components you can continue adding other components.

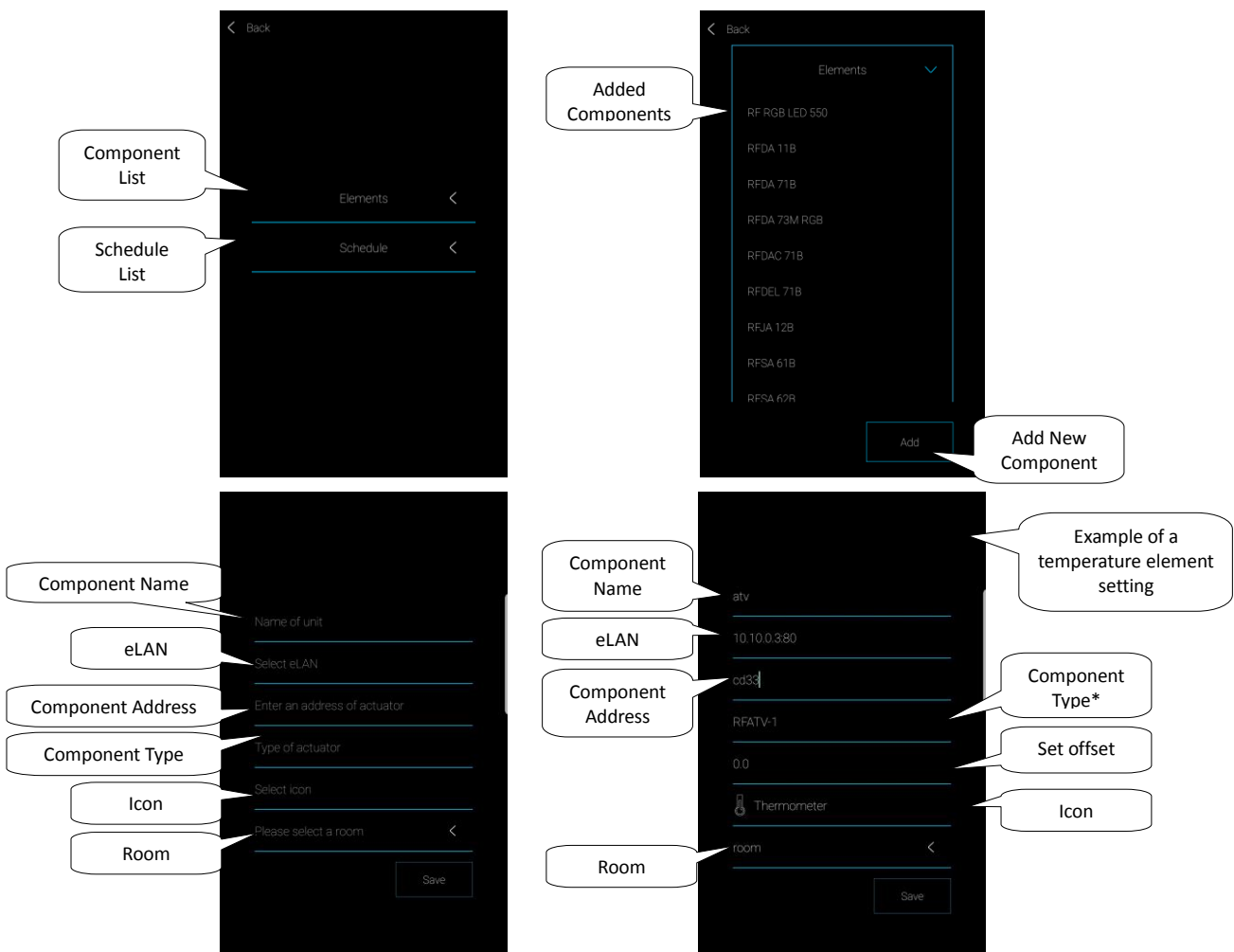

* When selecting the thermal component type, the field for the offset input is displayed in the application.

- RFATV-1 offset within ± 20 ° C, steps of 0.5 ° C
- RFTC-10/G offset within ± 5 ° C, steps of 0.5 ° C
- RFTI-10B offset within ± 20 ° C, steps of 0.1 ° C
- RFSTI-11B(G) offset within ± 20 ° C, steps of 0.1 ° C

For components with internal and external temperature sensor, offset can be set for each sensor separately.

**If you have the component already assigned to one eLAN-RF you cannot assigned to another. eLAN-RF IP address cannot be edited. The component must be removed from the original eLAN-RF and then assigned to the newly required eLAN-RF.

Touch schedule to display a list of added Schedules. Press *Add* button to enter the screen for creating the schedule.

- Schedule name - enter any name (with diacritics).
- Select eLAN - pressing on this field displays the IP address for the active eLAN-RF, where you can choose the desired eLAN-RF. Press the appropriate IP address to enter.
- *Select Features - Select a component or components from the list (the components that you want to assign to the same schedule; they must be from the same group, for example. Dimmer).

* Thermal components are set up in the Schedule in chapter: 5.2.6.3 Heating, see page 26.

Press *Save* button to confirm.

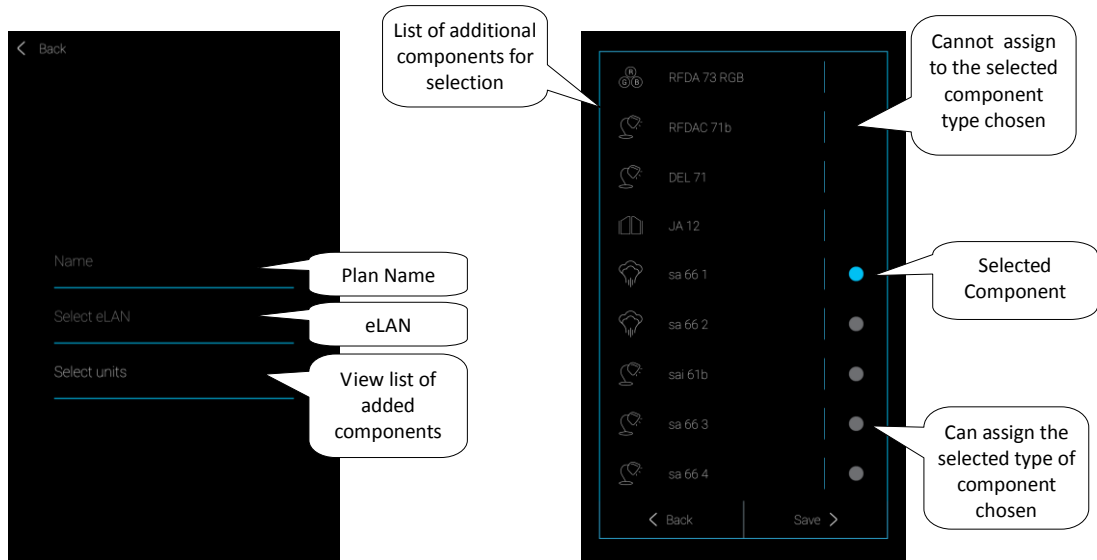

Displays a screen with a completed schedule, listing the various associated components. Touch the *Next* button to enter the schedule, the *Add* button to enter the setup screen where:

- Day - Select days of the week
- From - use the arrows to set the beginning of the function
- To - use the arrows to set the termination of the function
- Select function - according to the chosen group of components offers a selection of features for a set period of time. For dimmers there are set up four levels of brightness or colour temperature or light (depending on the type of dimmer). For switches to set the function on / off or crossing blinds up / down.

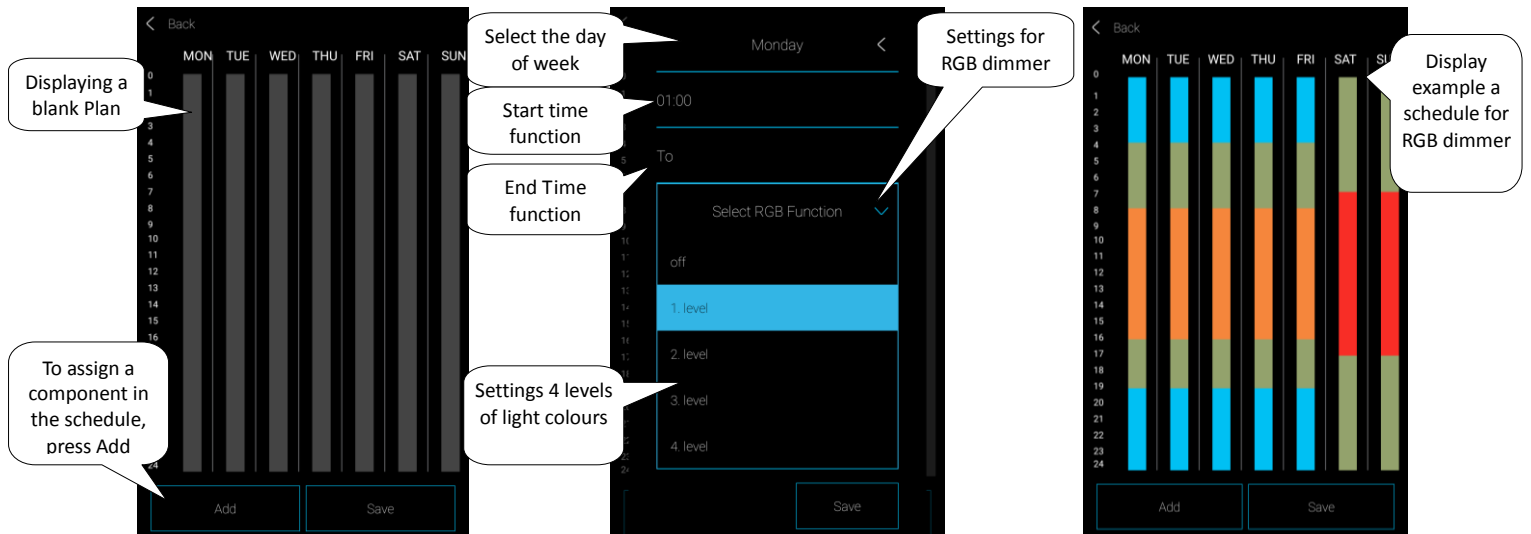

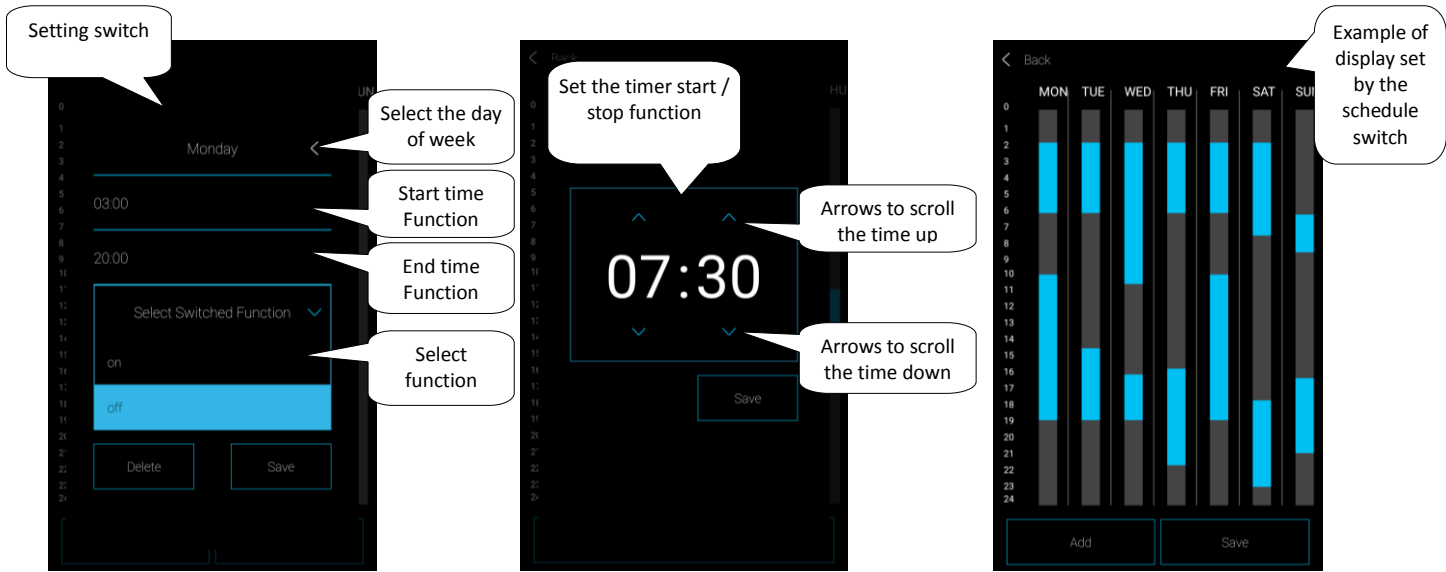

Press *Save* button to confirm the setting. Plan appears. The setting is in the column highlighted by the switch in blue, with dimmers in colour at the level set.

Press *Add* button to continue setting other schedules for selected component(s).

If you want to have the same settings on multiple days, touch the column set menu for copying. Touch on the required days to copy the schedule.

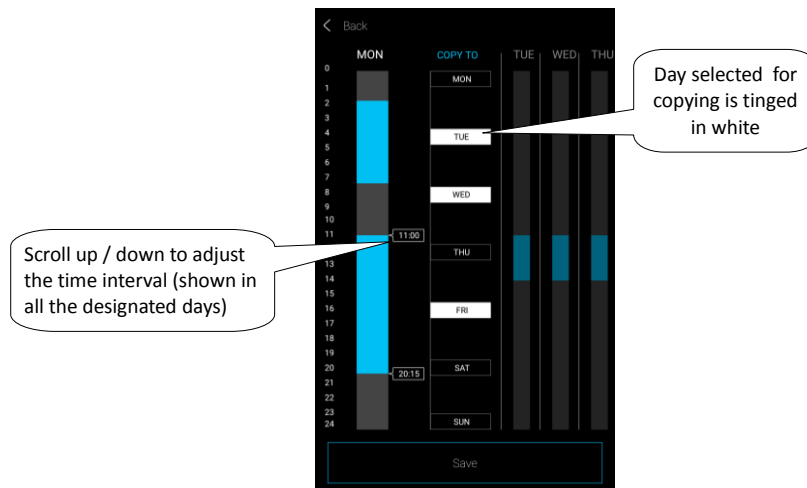

Press *Save* button to confirm the setting. Schedule appears. If you want to edit the settings generated, press and hold the desired section of the column you want to change. This opens the default settings that you can edit.

Touch the *Save* button to return to the *Components / Schedule*.

Editing Schedule – in the list of schedules, short press on the name.

Removing Schedule - schedule list by long pressing on the title.

Press the *Add* button in the list of schedules, continue adding other plans.

Return to the Settings menu - touch the *Back* button.

5.2.3 Rooms

Settings for **eLAN-RF-003** and **eLAN-RF-Wi-003** (hereinafter referred to as "eLAN-RF").

Used for adding, removing or editing rooms.

It creates room for better clarity. Each room is assigned to eLAN-RF. For better clarity, the set components assigned to individual rooms.

Press **Add** button, displays the settings:

- Name of the room - enter any name (with diacritics).
- Select eLAN - pressing on this field displays the IP address for the active eLAN-RF, where you can choose the desired eLAN-RF. Press the appropriate IP address to enter.
- Icon - pressing on this field displays the different types of icons offered. Press the icon you want to select it.

Press **Save** button to confirm the setting. Returns to the room list.

Removing the room, long press on the name of the room.

Touch the arrow in line with room to expand the list of components. Touch the required components to assign them to a room. Press the **Save** button to confirm the setting. Press the **Edit** button you can edit an existing room. The IP address of the eLAN-RF cannot be edited. The room must be deleted from the original eLAN-RF and then assigned the new one required. Press the **Add** button; you can continue to add other rooms.

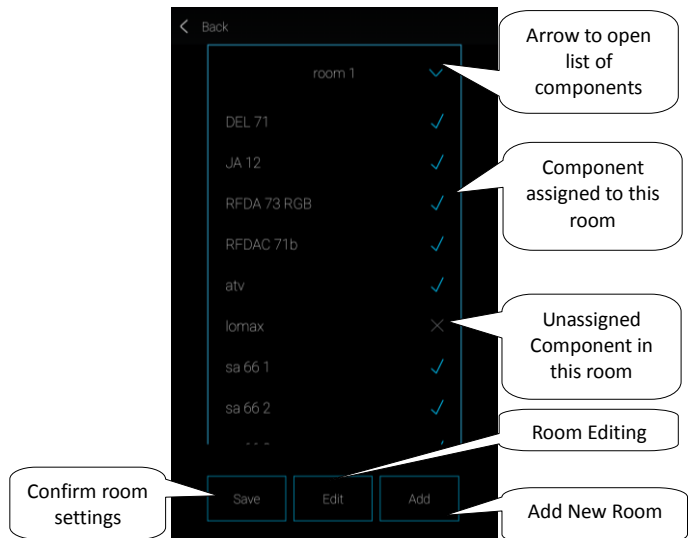
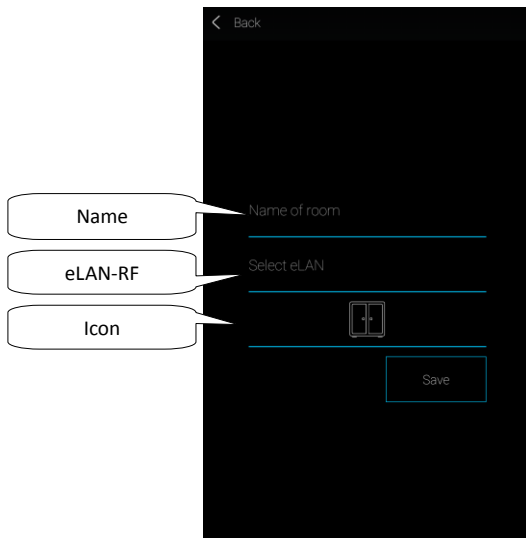

Return to the Settings menu - touch the **Back** button.

5.2.4 Scenes

Scenes are used to control multiple predefined settings, such as: Everything turned on / off or All blinds up / down, and others.

Pressing the *Add* button displays the settings:

- Scene name - enter any name (with diacritics)
- Select eLAN - press on this field displays the IP address for active eLAN-RF, where you can choose the desired eLAN-RF. Press the appropriate IP address you entered
- Select components - touch to select component, you can select the function* you set the scene as required. Pressing the *Back* button to return to the list of components, where you can continue to the next setting.

Press the *Save* button to confirm the setting. Displays a list of created scenes. Press *Add scene* button you can continue setting other scenes.

Editing Scene – short press of the name. The IP address of the eLAN-RF cannot be edited. The scene must be deleted from the original eLAN-RF and then assigned the new one required.

Removing scenes - long press of the name.

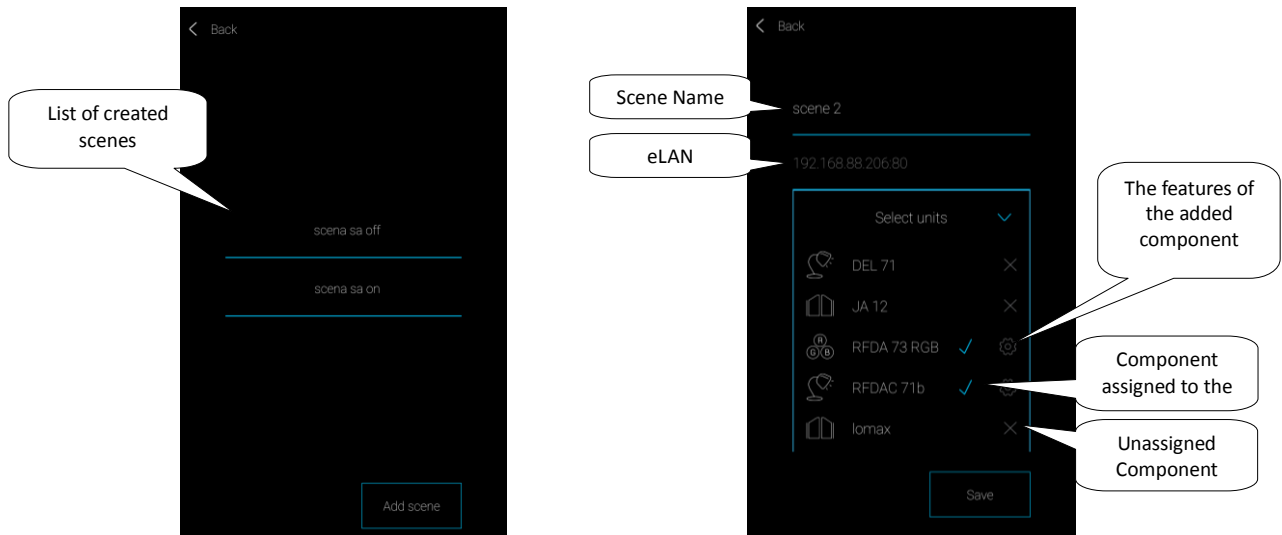

* Function varies depending on the type of component (switching, dimming ...)

Return to the Settings menu - touch the *Back* button.

5.2.5 Widgets

Widgets, to view and control the chosen components and scenes directly on the home screen of your mobile phone.

Press *Next* to the **Widgets** screen, you can skip this.

Press *Add* button, the widget box will appear: Components and scenes.

Press the *arrow* to display the list of components (scenes). By touching mark those which you want to pair with the function of the widget. Touch the *Back* button to return to the previous screen (not to confirm).

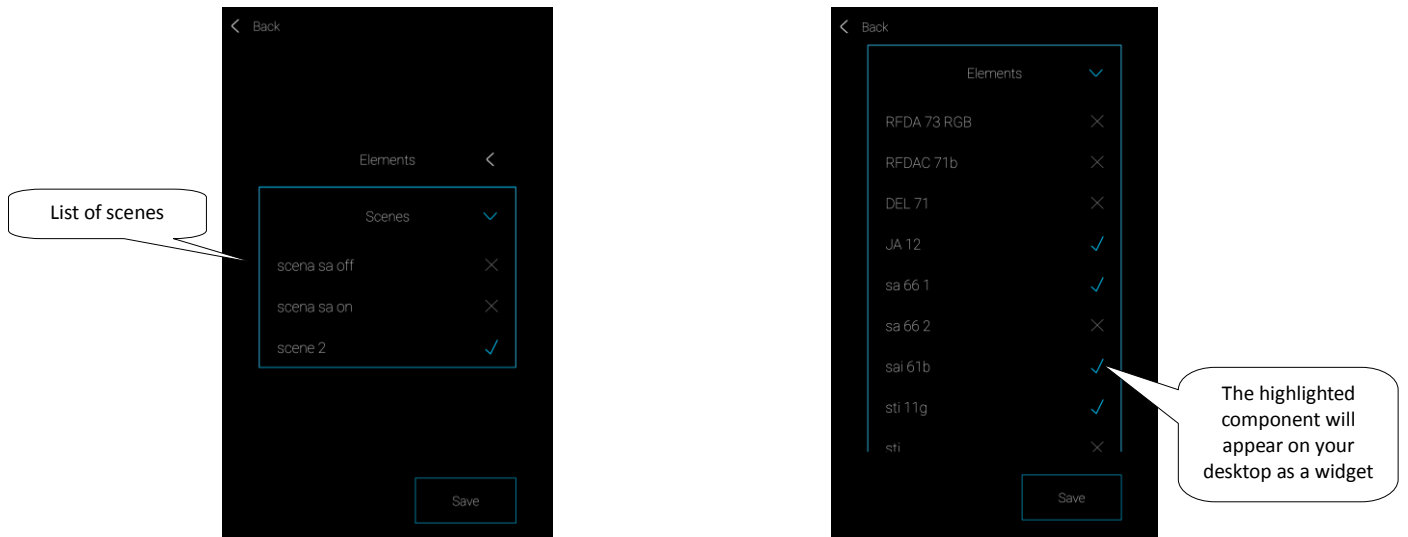

Note: Selected widgets must be activated on the main screen of the phone. In the list of available widgets, select Widget iHC-MAIRF CLOUD applications. The Widget is brought to the home screen. On the screen, you can adjust the size of widgets and customize the number of components that will appear on the desktop (the exact procedure may vary depending on the type of mobile phone).

The Widget displays the selected components that you can use the buttons on the right side to activate / deactivate or watch the set value (eg. For temperature sensors). If a widget has multiple components or scenes then the widget can display at one time, it activates the possibility of scrolling, so you can browse between the elements or scenes browse.

Updating the status of the components in the widget takes place every 10 seconds.

For properly widgets work, the application must be running in the background.

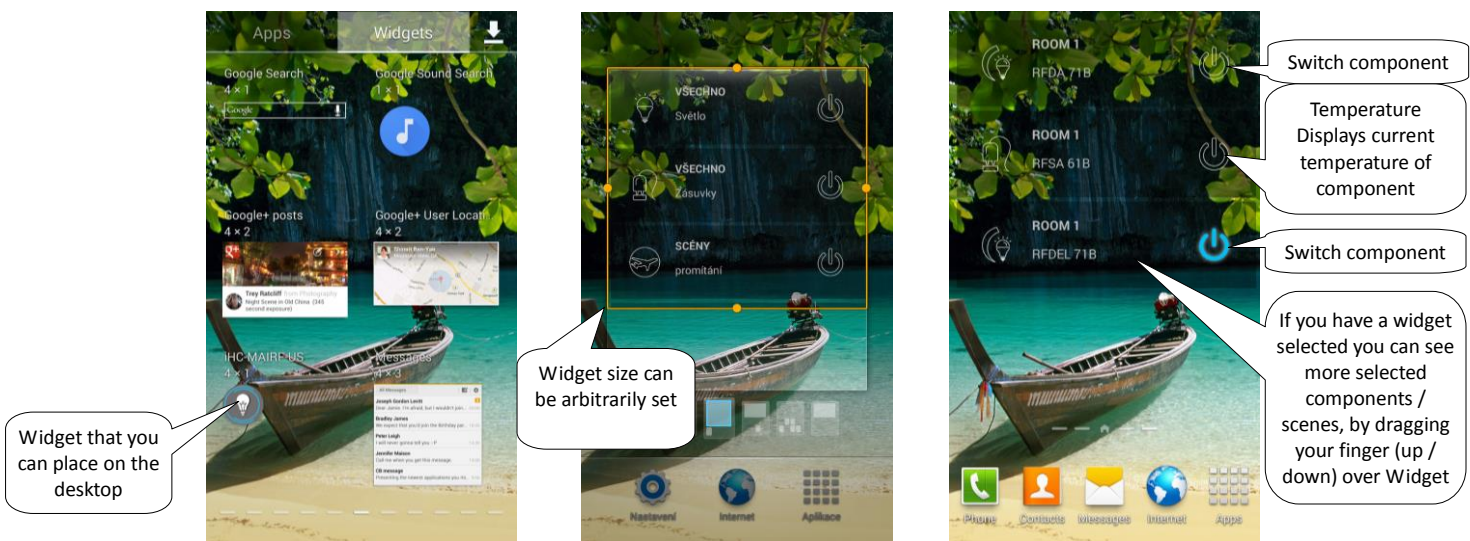

Return to the Settings menu - touch the *Back* button.

5.2.6 Advanced settings

In the advanced settings menu you will find:

1. Cameras
2. Intercom
3. Heating
4. Audio / Video
5. Weather
6. Other

5.2.6.1 Cameras

If you want to have a camera always "at hand", you can add them to the Quick View - tiles. In iHC applications the current image (stream) can be seen from domestic IP security cameras. Recommended cameras: iNELS Cam, Axis, custom.

Press *Add* button to open a menu with the IP cameras.

- Camera name - any name (with diacritics)
- Insert the camera address - Enter the IP address of the camera
When using other than the recommended IP cameras, enter the camera stream format MJPG into the *Address field*. Stream is obtained by e.g., the web interface or the camera manual. If the stream is not in the MJPG format the camcorder will not connect to the application (address format: IP address: port / MJPG / video.mjpg, an example of entering addresses: 10.10.5.142:80/mjpg/video.mjpg)
- Camera type - from the menu to select the type of camera settings
- Username - enter the username for access to camera
- Password - enter the password for access to the camera

Press *Save* button to confirm the setting. Displays a list of added cameras (application saves the settings and the camera automatically adds to the list of devices, *Camera tabs*).

Editing camera - a short press of the name.

Removing camera - long press of the name.

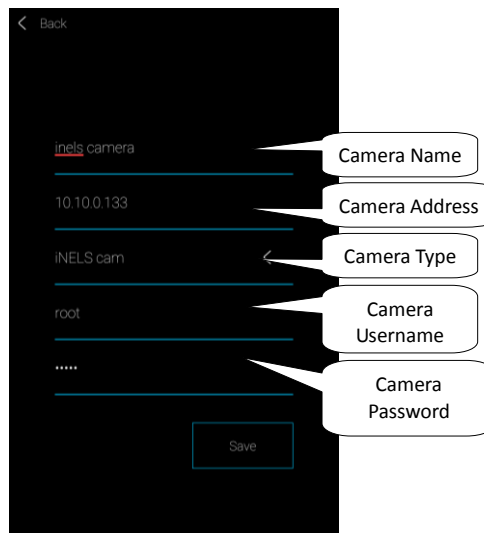

Return to the Settings menu - touch the *Back* button.

5.2.6.2 Intercom

Intercom allows data communication between the domestic audio units of 2N, iHC applications and IMM applications (video zone). Communication is by voice; in case of camera images are also transmitted. Selecting the type of device (Intercom or Dahua) displays possible settings of the associated device types.

Note: On the Web Interface server *Intercoms* tabs set: username, SIP username, password and video stream devices that in advance are arbitrary chosen for the equipment (sound, applications, IMM client) and save it. In the case of using Dahua voice, this step is similar. First, you must create contacts on the relative server.

Pressing the Intercom button, setting appears. Attention: all contacts voices and applications must be allocated on an IMM server or Dahua running Asterisk.

- Allow intercom - to activate the intercom
- **Select the type of equipment - Intercom**
- Name - the name of the SIP, the same as the IMM server
- Password - to the created SIP name
- Server address - the IP address of the IMM server or SIP server
- Contacts - press to download all contacts stored on the server (after downloading contacts, message confirming the successful download)
- Status - displays connection status (ON - connected, OFF - disconnected)

- **Select the type of device - Dahua**
- 2N SIP name - Dahua voice on SIP server
- 2N name - Username cameras
- 2N Password - The login password cameras
- Name - Name of contact registered on the server
- Password - A password registered to a contact on a server
- Server address - the IP address of the Dahua server
- Status - indicates connection status (ON - connected, OFF - disconnected)

Caution: The Dahua door-phone configured without the connection server may not be compatible with all mobile phone models. We recommend that you use the Connection Server as a SIP server that handles the connection.

Pressing the *Reset* button to connect to the specified server. Press the *back* button to exit the changes and return to the menu.

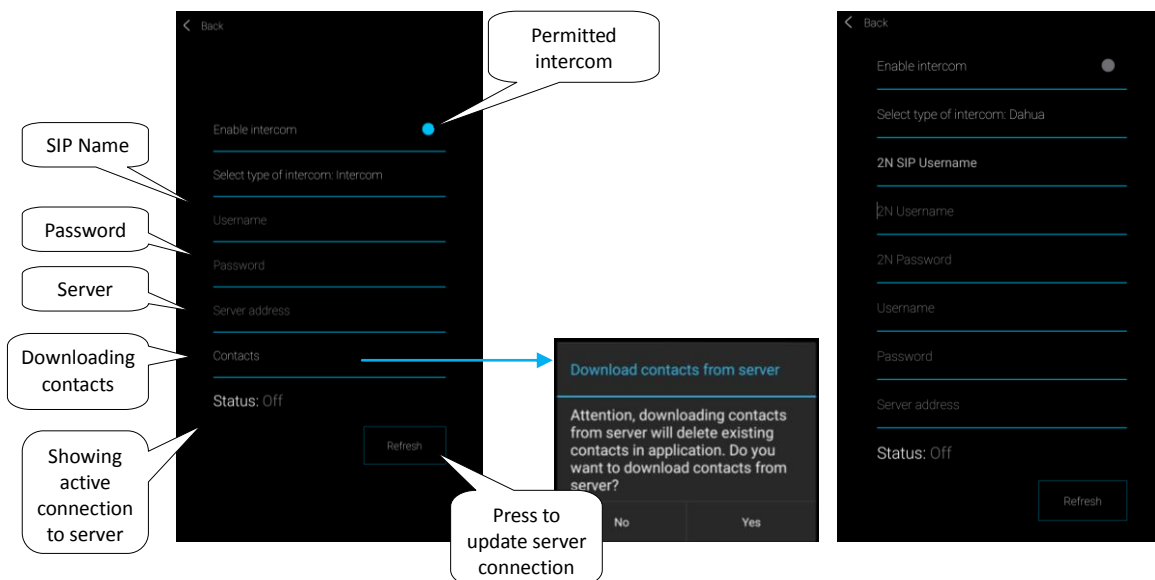

Editing contacts - can be made only on the IMM server.

Remove a contact - can only be done on the IMM server.

Editing intercom - is possible after you reopen the Intercom menu.

5.2.6.3 Heating / Cooling

You can control heating / cooling from the central source in the application to control e.g. a RFATV-1 thermo-valve mounted on a heater valve. Pressing Heating/Cooling button, a menu appears: The schedule, the heating circuit and the central source. (RFATV-1 thermo-valve can only be used for heating).

➤ **Time schedule** – setting temperature and cooling modes in weekly schedule

Touching on *Schedule* displays the list of time schedules added. Press *Add* button to displays the settings:

- Schedule name - enter any name (with diacritics).
- Select eLAN - pressing on this field displays the IP address for the active eLAN-RF, where you can choose the desired eLAN-RF. By pressing the appropriate IP address you entered.
- Component Address - enter the six-digit code shown on assigned component.
- Hysteresis - set upper and lower limits of the range 0.5 ... 5 °C (If it is part of the thermo-valve heating circuit RFATV -1 as a component for heating, from the central source where the percentage set can be controlled and is switched so the thermo-valve is open at 5%. The command is given to switch to close for less than the percentage set. - does not follow the set hysteresis).
- Set temperature modes - the possibility of modifying the pre-set temperature for each mode (minimum attenuation, normal and comfort).
- Setting cooling modes- the possibility of modifying the pre-set temperature for each mode (minimum attenuation, normal and comfort).

Touch the *Next* button to enter the Schedule, default minimum temperature regime. Press *Add* button to displays the settings:

- Day - Select days of the week
- From - use the arrows to set the beginning of the heating mode
- To - use the arrows to set the end of the heating mode
- Temperature Modes - Select the desired temperature mode for a set period of time

Touching the *Save* button returns to the Schedule, pressing the *Add* button, you can continue setting other time intervals.

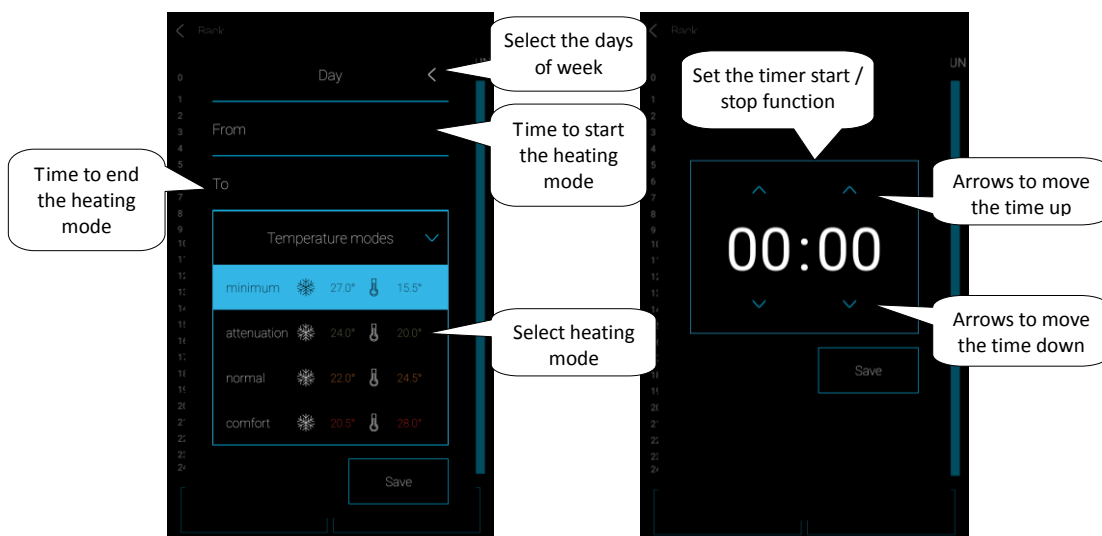
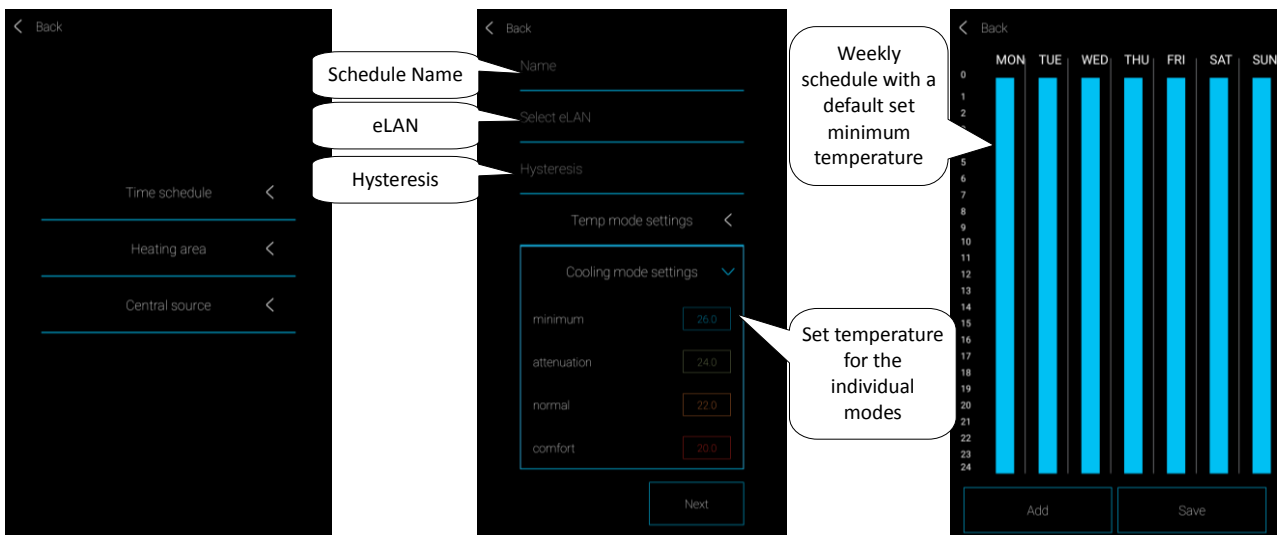

Press *Save* button to confirm the setting. The Schedule appears. The setting in the column is highlighted in colour according to the pre-set temperature regime. If you want to set the same for several days, touching on the set column opens a menu for copying. Touch on the required days to copy the set schedule.

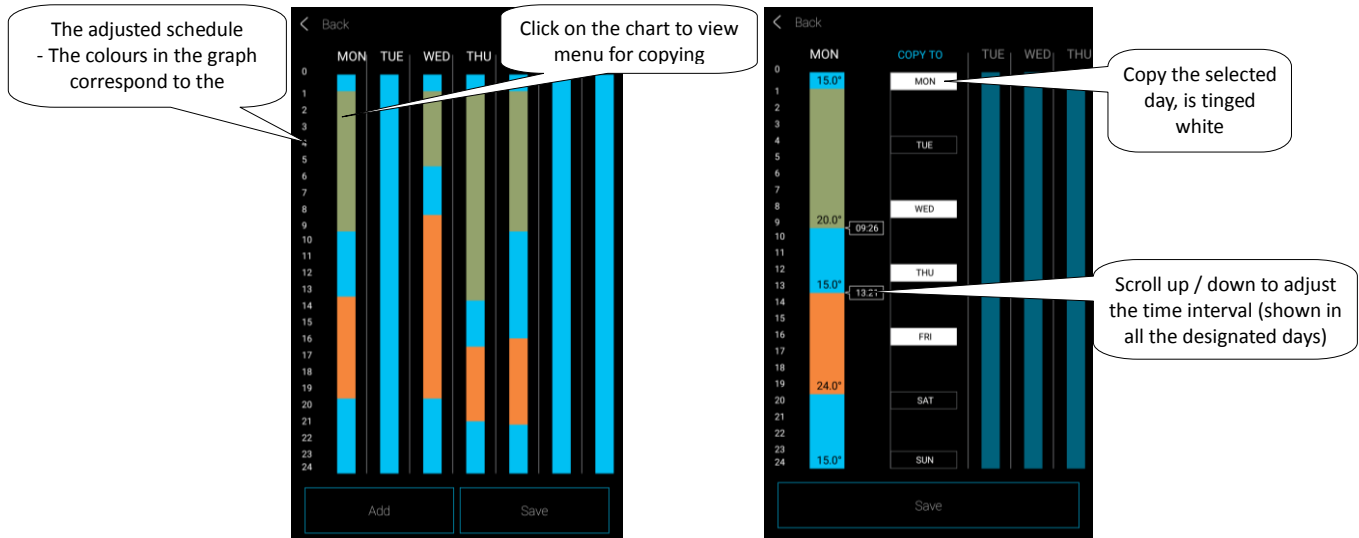

Press *Save* button to confirm the setting. Schedule appears. If you want to edit the settings generated, press and hold the desired section of the column you want to change. This opens the settings that you can edit.

In the list of schedules:

Editing schedule - short press of the name.

Removing schedule - long press on the name.

Press *Add* button, you can continue adding other schedules.

To return to the *time schedule*, the *heating circuit* and *Central source* - touch the *Back* button.

Return to the Settings menu - touch the *Back* button.

➤ **Heating circuits** – Monitor the temperature using the selected sensor in the room.

1. Once the temperature drops below a set level ± hysteresis and components for the room to be heated start to heat, (opens thermal head for heating valve, relay switches for electric heaters, etc.).
2. Or they can keep cool in the room.
For better clarity, we recommend heating circuits to create a separate room (see. Chapter rooms, page 21).

Touching on the *heating circuit* displays a list of heating circuits added. Press Add button to displays the settings:

- Name heating circuit - enter any name (with diacritics)
- Temperature sensor - in the list, select the component (if component is connected to more temperature sensors, select from the menu required) *
- Temperature schedule - select from the list
- Holiday schedule - choose from a list (used for the temporary interruption of the schedule adjustment, is not required).
- Select heating - select features for controlling the heating temperature circuit. If you mark the component field *Central source*, you must then set the temperature circuit as *Central source* (see next page).

For one heating circuit Multiple central sources can be assigned, but they can not combine their on / of switching.

- Select cooling - select features for controlling the cooling circuit temperature. If you mark the component field *Central source*, you must then set the temperature circuit as *Central source* (see next page).

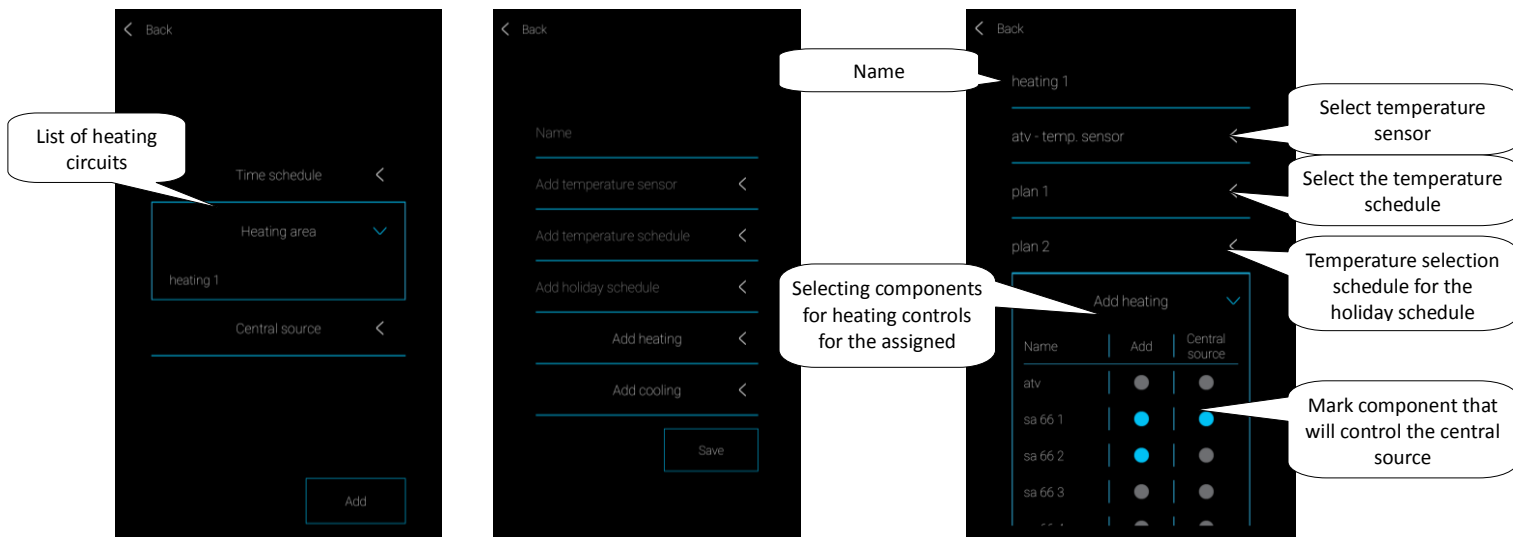

Press *Save* button to confirm the setting. Press the *Add* button continue setting other heating circuits.

Editing circuits - short press of the name.

Removing circuits - long press on the name.

To return to the time schedule, *the heating circuit* and *Central source* - touch the *Back* button.

Return to the Settings menu - touch the *Back* button.

* RFTI-10B option of internal / external sensor.

RFTI-11/G: a choice between internal and external sensors and mixed mode (mixed mode - measured space temperature sensor internal and external sensor monitors the critical temperature of the floor, when exceeding of the critical temperature occurs the floor heating is turned off regardless of the temperature measured by the internal sensor).

➤ **Central source**

Touching on *Central source*, list appears of central resources added. Press *Add* button to displays the settings:

- Name a central source - any name (with diacritics)
- Select eLAN - press on this field displays the IP address for active eLAN-RF, where you can choose the desired eLAN-RF. By pressing the the appropriate IP address you entered.
- Use Percentage Control - only for RFATV-1 therm-valve, touch (blue dot) / deactivate function.
 - Percentage of control - if Percent control is active, 5, 10, 15 or 20% opening of the thermos-valve can be set. The set value is the standard for switching from the central power source.
- Element - Select component from the list, which will operate a central source.

ATTENTION: The combination of central switching resources must be addressed during the electrical installation.

- Heating circuit - from the list, select the heating circuits that are connected to a central source.
- Mode - Activation of the central cooling or heating source or both (If the heating with the central source is defined in the heating circuit, it is necessary to activate the heater function, otherwise cooling or both).

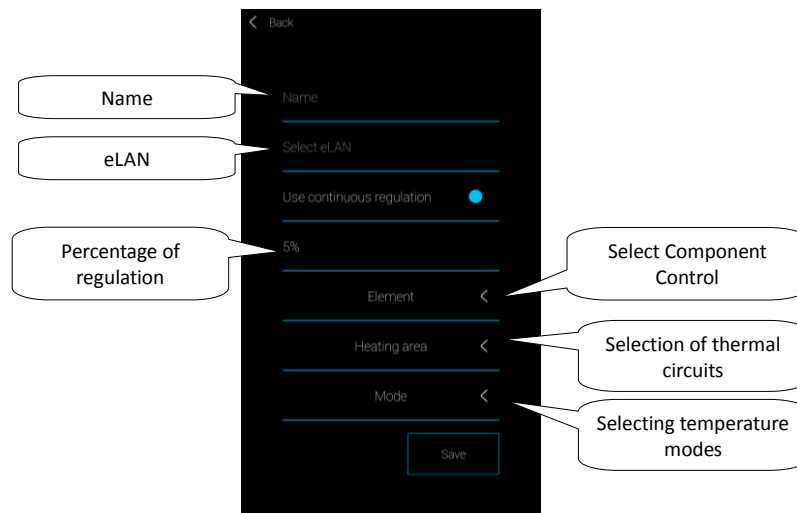

Press *Save* button to confirm the setting. Press the *Add* button to continue setting other central sources.

To return to the time schedule, the heating circuit and a central source - touch the *Back* button.

Return to the *Settings* menu - touch the *Back* button.

5.2.6.4 Audio/Video

Settings for **eLAN-IR-003** (hereinafter referred to as "eLAN-IR").

In setting Audio / Video can pair your remote control with IR-eLAN. After that, you can control television, radio, air conditioning and more.

Pressing *Audio / Video* settings will appear:

- Driver Name - enter any name (with diacritics)
- Select eLAN - press on this field displays the IP address for active eLAN-IR, where you can choose the desired eLAN-IR. By pressing the the appropriate IP address you entered.
- Icon - press on this field displays offer different types of icons. By pressing the icon you want to select it. *
- LED - select LED (by connecting an IR sensor to eLAN-IR).

Press *Next* button. The first part of the graphics for remote control with predefined buttons appears. Slide your finger up the screen to see the second part of the graphics.

* If you select the icon for air displays graphics controller for air conditioning.

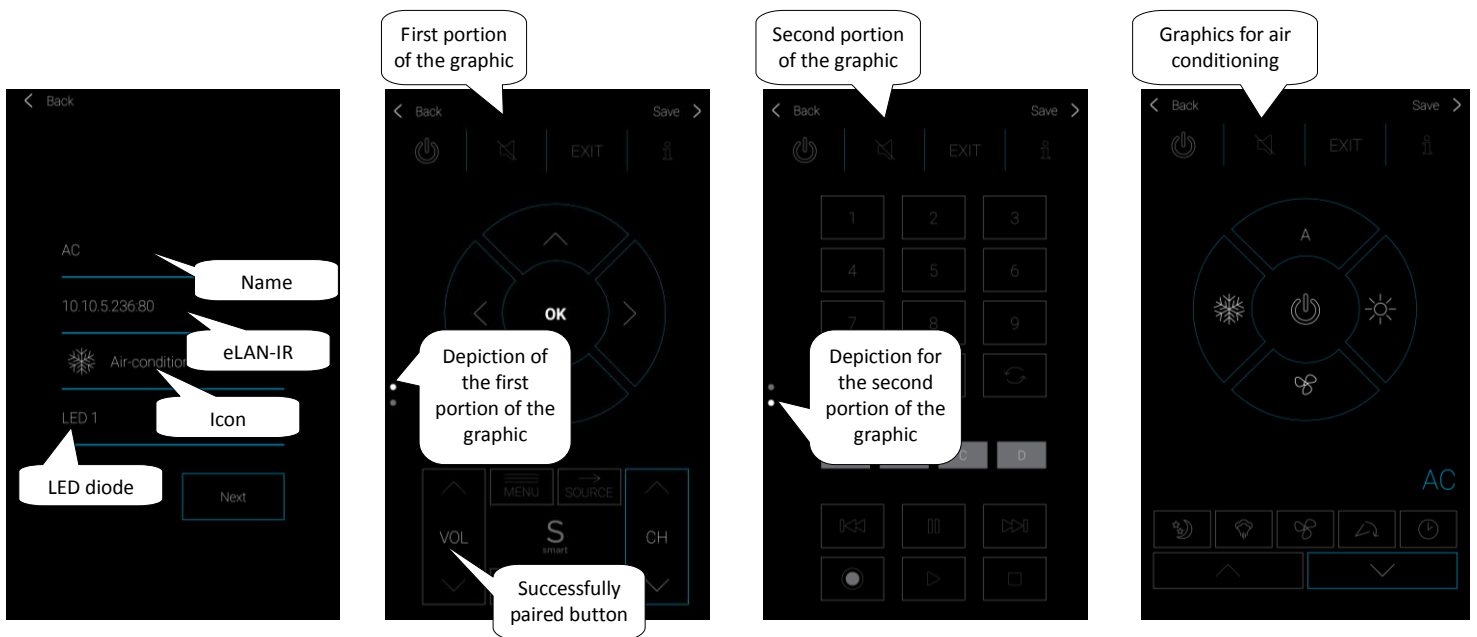

For pairing applications with the buttons on the remote control the remote must be located closest to eLAN-IR, IR sensor pointed at the IR receiver IR LEARN.

Press the buttons on the screen - displays the warning "Please wait." On the remote, press the desired button. If the pairing is successful, the outline of the buttons will turn blue. In the same way you pair all the required buttons

Note: If any of the buttons you have programmed does not work as described above reprogram it.

Drivers created will be displayed in a separate IR room. IR Room is created automatically - you do not have assign drivers anywhere.

Press Save button to confirm the setting. The drivers. Press the *Add* button continue setting other drivers.

Return to the Settings menu - touch the *Back* button.

5.2.6.5 Weather

The *Weather* tab allows you to view the current status of temperature, humidity, wind speed and pressure. The application can connect to the web application OpenWeatherMap, which allows the display of current weather conditions anywhere in the world. Or linking the application with weather station GIOM 3000, which offers current values directly from the place where it is located

Pressing *weather* button selection appears: *OpenWeatherMap* or *Giom*.

Touching *OpenWeatherMap*, setting appear:

- Latitude*
- Longitude*
- Select eLAN - press on this field displays the IP address for active eLAN-RF, where you can choose the desired eLAN-RF. By pressing the appropriate IP address you entered.

* Required geographic coordinates e.g. The assistance of Web display maps where these enumeration data directly from a link on the page or view detailed information about the desired location. For proper localization enter at least two decimal places.

Press *Save*. Confirm the settings by pressing the *Apply* button. If the coordinates are correct, confirms with message Applied. If the message does not appear the applied entered coordinates are not accurate enough and need to be clarified by specifying more than two decimal places.

Touching *Giom* setting appears:

- IP address - the IP address of the weather station
- Port - enter the port number of the weather station
- Select eLAN - pressing on this field displays the IP address for active eLAN-RF, where you can choose the desired eLAN-RF. By pressing the the appropriate IP address you entered.

Press *Save*. Confirming the settings by pressing the *Apply* button.

For the current weather display must touch the *Other* tab to activate *View weather*.

Return to the Settings menu - touch the *Back* button.

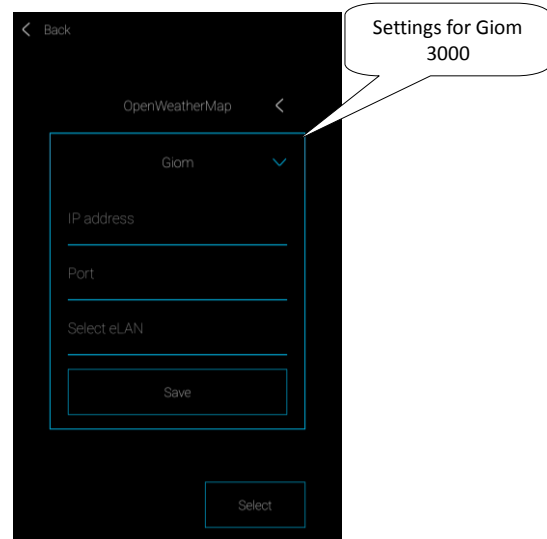
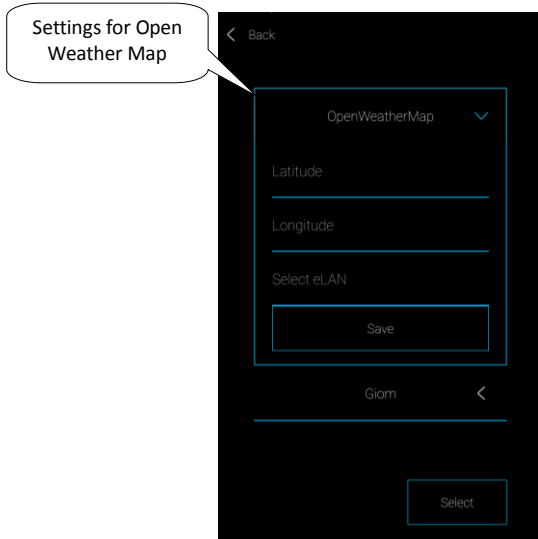

5.2.6.6 Other

- *Enable Cloud features* – activation: the application displays options for login, configuration, and deactivation: removes cloud options from the application.
- On checking time in eLAN - function monitors time synchronization eLAN-RF and applications (e.g. If the eLAN-RF is not connected to the Internet). If there is difference of more than 5 minutes, the application displays a warning
- *Show weather* – Activation weather display in the initial screen
- *Switch on white design* - graphic changes to white
- Download the latest firmware - used to download the latest firmware to your mobile phone.
- *Update eLAN* – Perform the FW update if you are connected to the application in the local network. Using a public address, the upgrade may not always succeed (this also applies to VPN connections).
- *Download eLAN settings* – Downloads the current settings of the selected eLAN phone
- *Upload eLAN settings* – Load settings from the phone to eLAN
- *Guide* – start guide to applications
- *License* – displays information
- *Repeat saves components* – re saves all components and heating circuits stored in the eLAN
- *Přeuložení konfigurace cloud* – reloads elements in eLAN and creates a new connection to the cloud

Return to the Settings menu - touch the *Back* button.

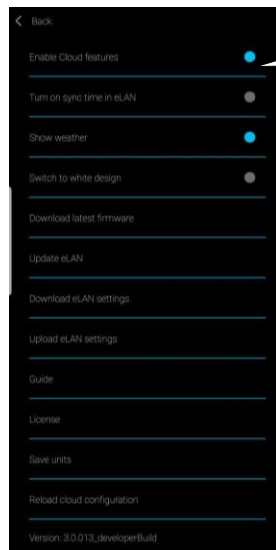

A blue dot indicates enabled item

5.3 Help

Press the *Help* button in the application, menu displays the manual in PDF format.

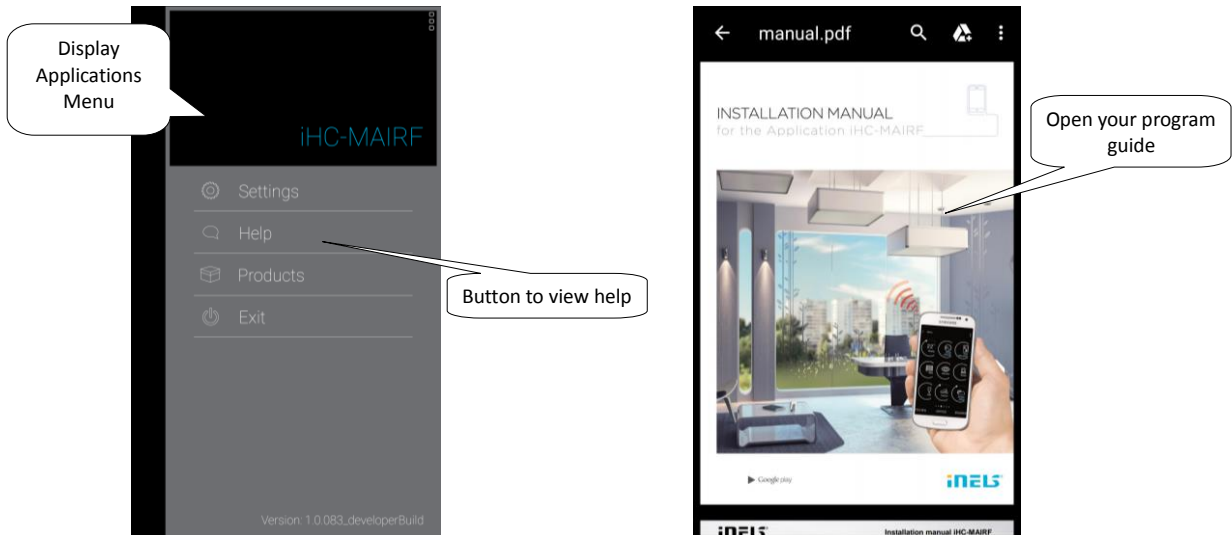

5.4 Log out

If you want to log out from an application, press the Menu button *Log out* of application.

You will then be asked: "Do you really log out?"

To logout confirm by pressing the *OK* button to return to the application, press the *Cancel* button.

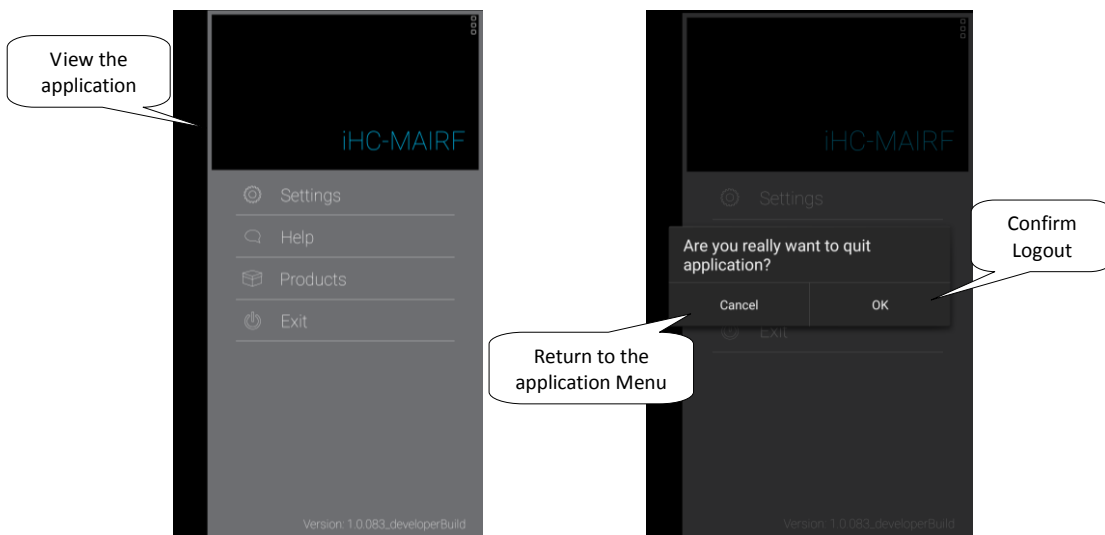

6. Control

On the basis of the previous steps the settings you will see the splash screen to control when the application starts:

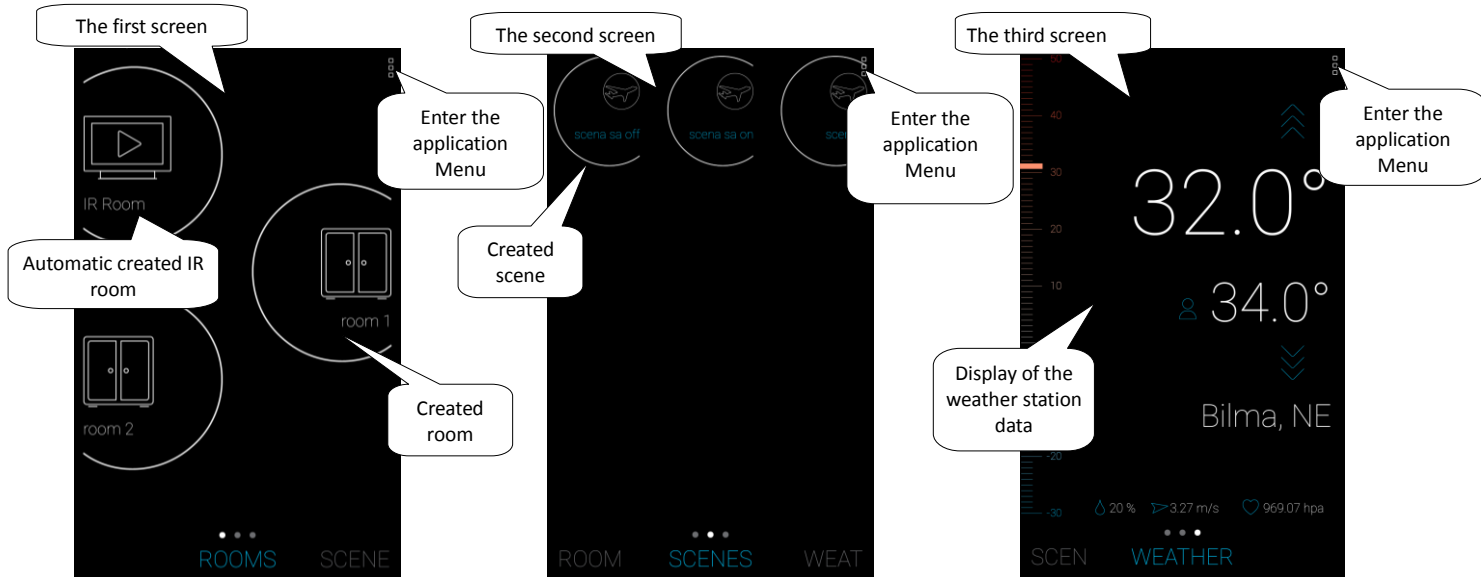

Overview of rooms, the room that you set. If there are no rooms are set in the application, a blank page appears with the word **Components**.

Scenes – an overview of the scenes that you have created. Short press the icon you can turn scenes on/off.

Weather overview of up-to-date information about the weather: temperature, humidity, wind speed, pressure, ... (appears only when you have enabled View).

In the event that you have stored the camera, the **Camera** tab displays to the left of the rooms.

Bookmark on the right is displayed for **Intercom** bookmarked weather.

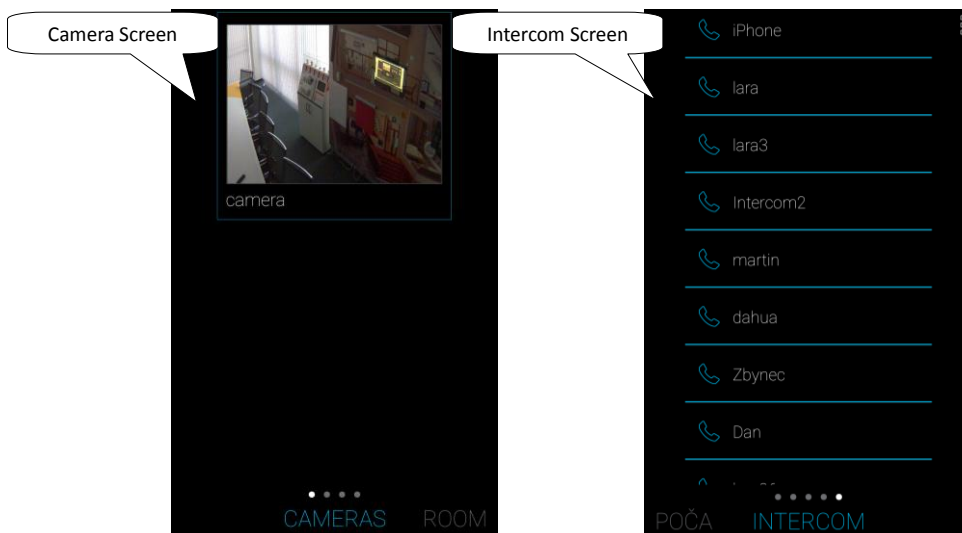

Between the screens, you can scroll through with a stroke of a finger across the screen to the right/left. Screen names are listed at the bottom, the name of the current screen is located in the middle and coloured in blue, previous/next screen are gray.

6.1 Rooms

Press on the icon of the **Room** to display the components that are assigned to the room. You can manually control by pressing the **Elements** directly from the screen.

Description component icons of the elements:

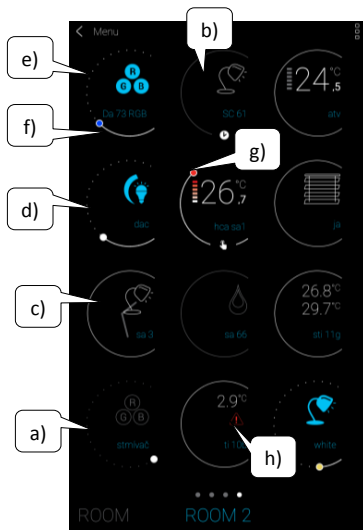

- a. Gray icon, gray margin: the application does not have a connection with the component, does not know its status-cannot be controlled
- b. White / blue icon, grey edge, the clock symbol at the bottom of icons: the component is in the automatic scheme – you cannot manually control
- c. White, white border: icon component is switched off/inactive
- d. blue icon, a white border: the component is turned on/active
- e. Dimmers: the solid line indicates the size (intensity) of the set brightness
- f. Components for lighting: the scroll bar colour indicates the colour of the light set
- g. Temperature controls: Colour scroll bars and symbol indicates the set temperature mode, coloured rectangles indicate the heater is turned on
- h. For thermal components: a warning triangle - the problem with temperature (temperature sensor element not connected, the batteries are discharged ...)

Output status indicators are updated automatically when you change the status of any component, mode, temperature or other variables.

Short touch the icon of the desired component, you can easily turn on/off.

Long touch (> 2s) the components icon opens the extended menu for the component control according to its type.

AUTOMATIC mode – I.E. Works on a set schedule, and directly from the screen cannot be manually controlled.

Important: after the failure of the power supply:

- During the schedule (Automat) - returns to the set timetable.
- When manually set - returns to the set timetable.
- If the component is manually switched off - remains off.



- by touching the information panel, the element with discharged battery is displayed.

6.1.1 Controlling dimmers

Dimmers you can according to the type of the components control the settings of brightness, colours, lights, timing or turn on/off.

• **RGB dimmer**

To control the dimmers with RGB options you have a menu available to set the color, brightness, and lighting up mode.

The value of colour and brightness you can adjust the slider.

Turn on the dimmer – touch the ON button: the light will light up to the last set value of the brightness and colour. At the same time it becomes an off button (OFF).

CIRCUS-this function changes the sequence of colours for your RGB dimmer at defined intervals.

AUTOMATIC button, you can activate/deactivate the switch-on time schedule.

Return to the start screen-touch the *back* button.

• **Other dimmers**

When you see the control of dimmers available menu to adjust the brightness and timing.

You can adjust the brightness value with the slider.

Turn on the dimmer – touch the ON button: lights light up to the last set brightness value.

Dimmer Off – touch the OFF button.

For multifunctional components in the upper right of screen use the *next* button to set the time for the gradual switching off/lighting up. Use the arrow keys up/down to set the desired time (2s-30 min), to confirm press the button to decrease (Increase). If the timing is active, it appears on the icon for the timing clock control.

AUTOMATIC button, you can activate/deactivate the switch-on time schedule.

Return to the start screen-touch the *back* button.

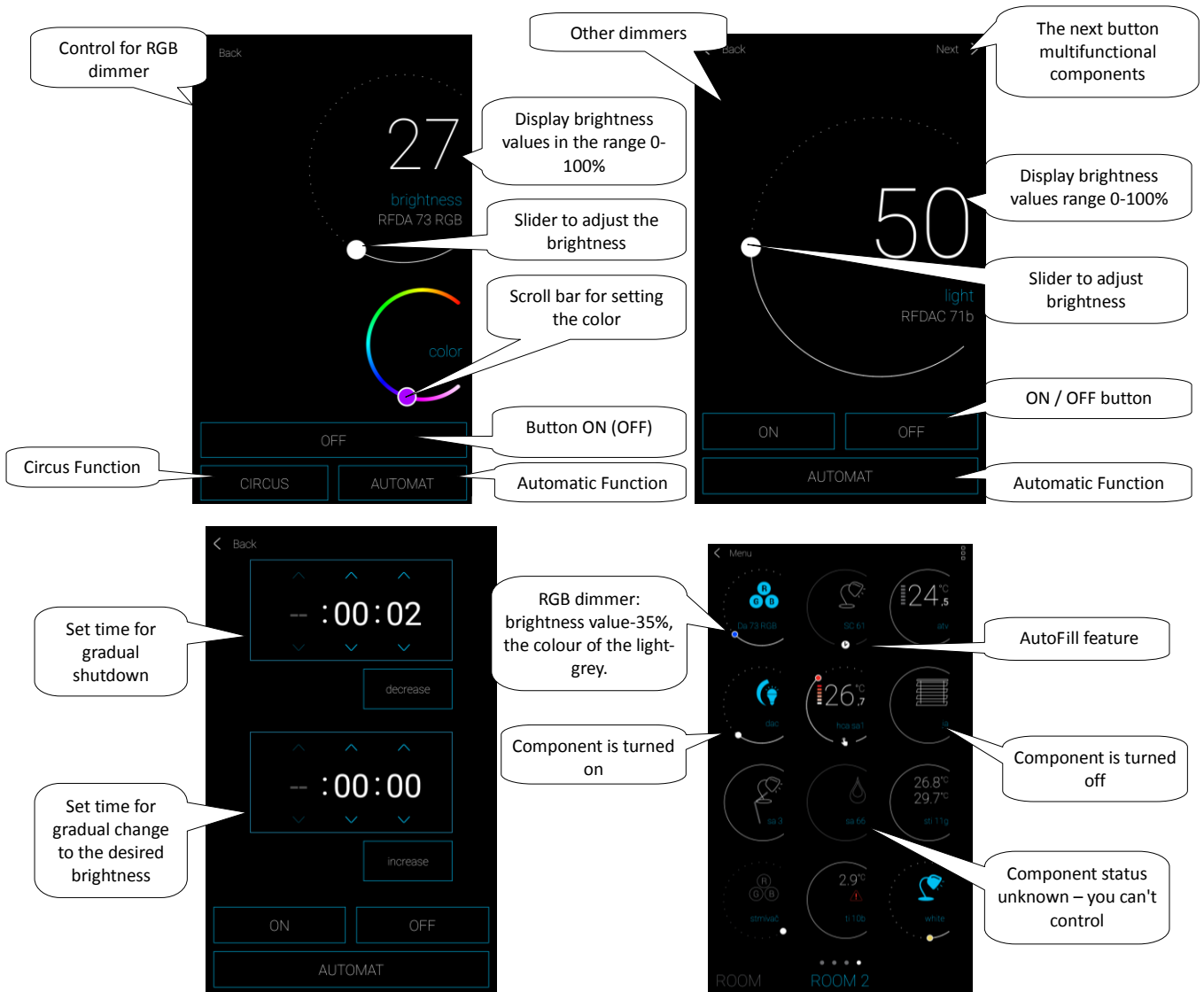

6.1.2 Controlling switches

- **Switch for Blinds**

UP Button -after pressing the blinds are up for a set period of time.

DOWN Button– after pressing the shutters are down for a set period of time.

STOP Button – stop the blinds at the time of moving up or down.

AUTOMATIC Button You can activate/deactivate the switch-on time schedule.

The time setting of the moving is displayed press the *next* button. Use the arrow keys up/down to set the desired time (in the range 1s-4 min), confirm by pressing *Set*. The set time is valid for both directions. While setting the time *Automatic* must be off. The set time is valid also for adding to scenes.

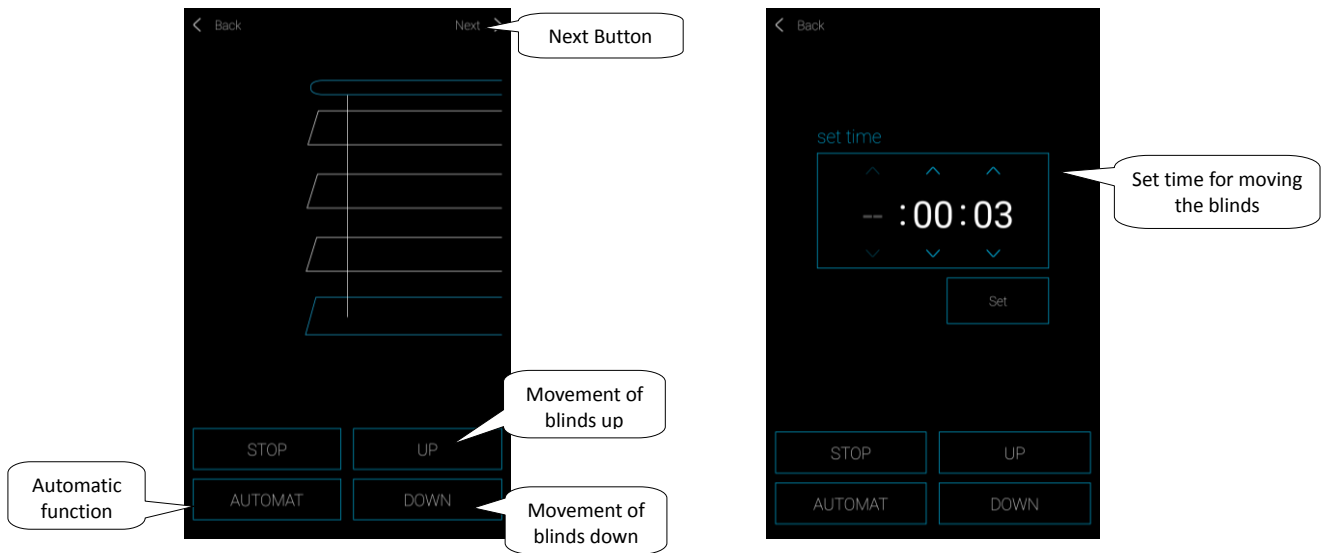

- Control for garage door**

STOP button - press the button to stop the garage door. Application indicates unknown status.

OPEN button - after pressing the button, the garage door moves to the upper end position.

CLOSE button - After pressing the button, the garage door moves to the lower end position.

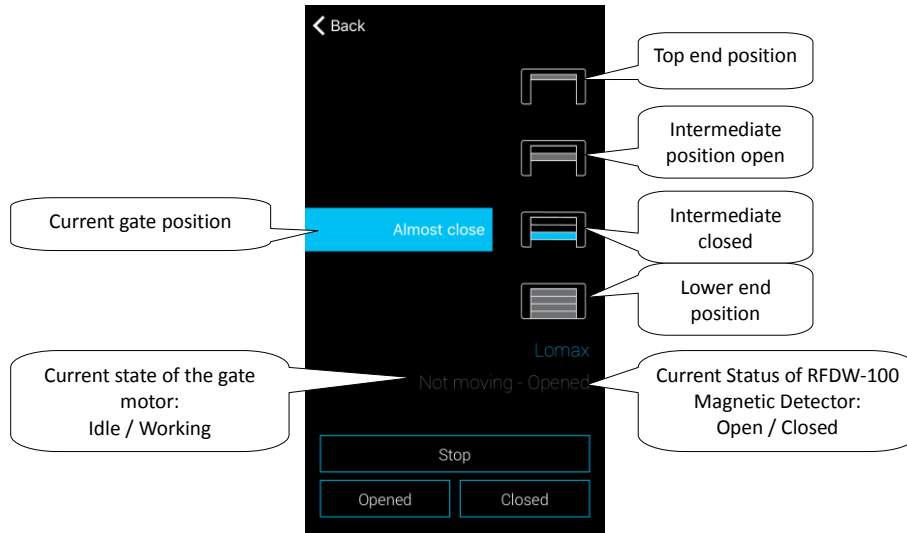

Indication of individual component states in the rooms:



- Blue doors or their parts - showing the current location.

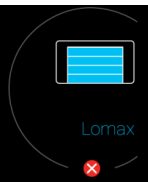

- Indication of manipulation with the magnetic detector (opening the cover, damage ...).

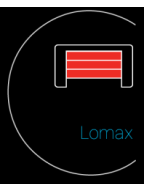

- Indication of manual door opening, application does not know position.

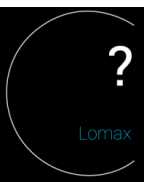

- Unknown gate position, move to position to one of the extreme positions.

• **Detectors**

The RFMD-100, RFWD-100 and RFSF-1B detectors must be assigned to the room as well as other actuators.

Detectors can be added to scenes where they can be activated / deactivated according to a predefined setting.

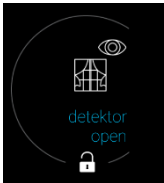

- Open lock - disarmed state (inactive detector)

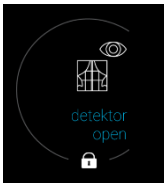

- Closed lock - Armed state (active detector)

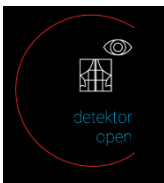

- Red indicator around the icon - detection (alarm)

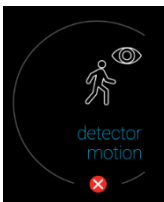

- Tamper indication (disruption of the cover)

The screenshots illustrate the following states:

- Disarming - Inactive detector:** The interface shows a 'DISARM' button and a 'detector' icon with a grey circle.
- Turn on detector - active detector:** The interface shows an 'ARMED' button and a 'detector' icon with a grey circle.
- Detection indicator (alarm):** The interface shows a 'detector' icon with a red circle, and a red bar at the bottom with 'ALARM! detector' and a close button.
- Detection indicator (alarm):** The interface shows a 'detector' icon with a red circle, and a red bar at the bottom with 'ALARM!'.

By touching the cross on the alarm indication on the bottom bar, the notification can be cancelled.

By touching the detector icon (in the room and with the open detector), the detector alarm can be deactivated.

• **Other Switches**

Switches you can set the two functions-delayed turn on or off.

Use the arrow keys up/down to set the desired time (2s-60 min), confirm by pressing *Set*. While setting the time *Automatic* must be turned off. If the timing is active, it appears on the icon for the timing control for hours.

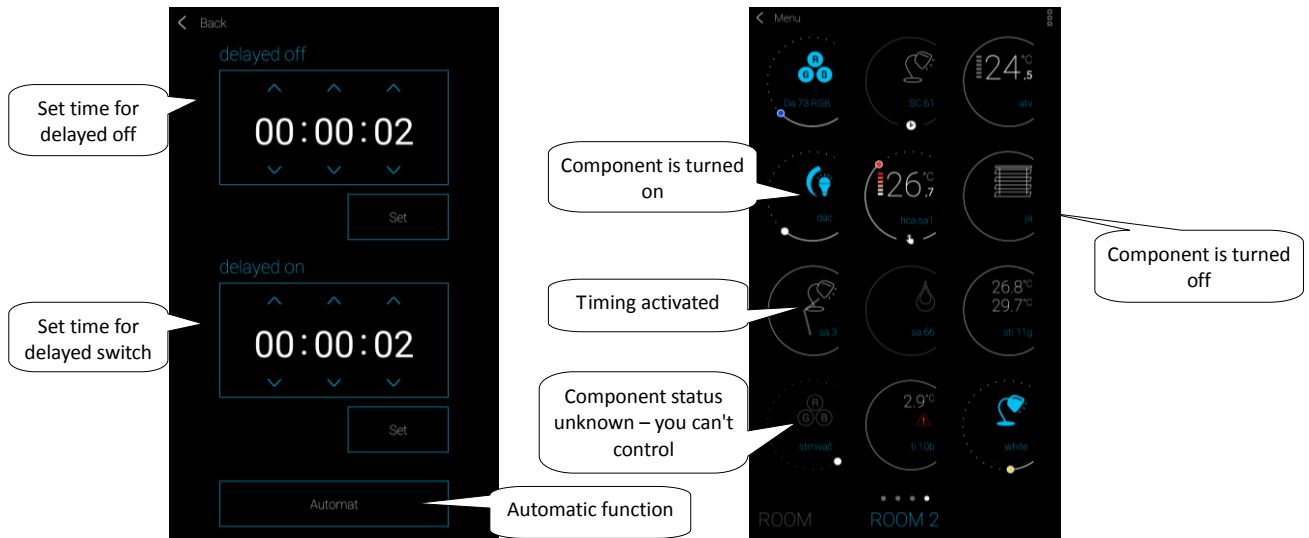

6.1.3. Temperature control components

• **Therموالve**

Long press on the icon *thermo-valve* in the room to add and view its settings. In therموالve, you can use the slider control to set the temperature in the range of 0-32°C. Displays:

- set temperature
- current temperature
- information display of battery status (red indicates a low battery)
- turn on window detection function (function follows the sharp drop in temperature in the case of window opening and closing RFATV-1 for a pre-set time) Red-fce is turned on
- view the status of open head

Press the *next* button in the upper right of the function settings menu appears *Window detection*:

You can choose to:

You can choose 3 levels of open window detection sensitivity, or switch the function off .

- Low sensitivity - drop in temperature by over 1.2 °C /min.
- Intermediate sensitivity - drop in temperature by over 0.8 °C /min.
- High sensitivity - drop in temperature by over 0.4 °C /min.

Idle time: the time period (in the range of 0-60min.), After which the heating is stopped when the opening of the window is detected.

Status opening thermo-value indicates the number of lit rectangles with icons.



- 1 rectangle: 5-22%
- 2 rectangles: 22-37%
- 3 rectangles: 38-53%
- 4 rectangles: 54-69%
- 5 rectangles: 70-85%
- 6 rectangles: 86-100%

With any manipulation of batteries RFATV-1 (eg. Replacement) always recalibrate the thermalvalve *.

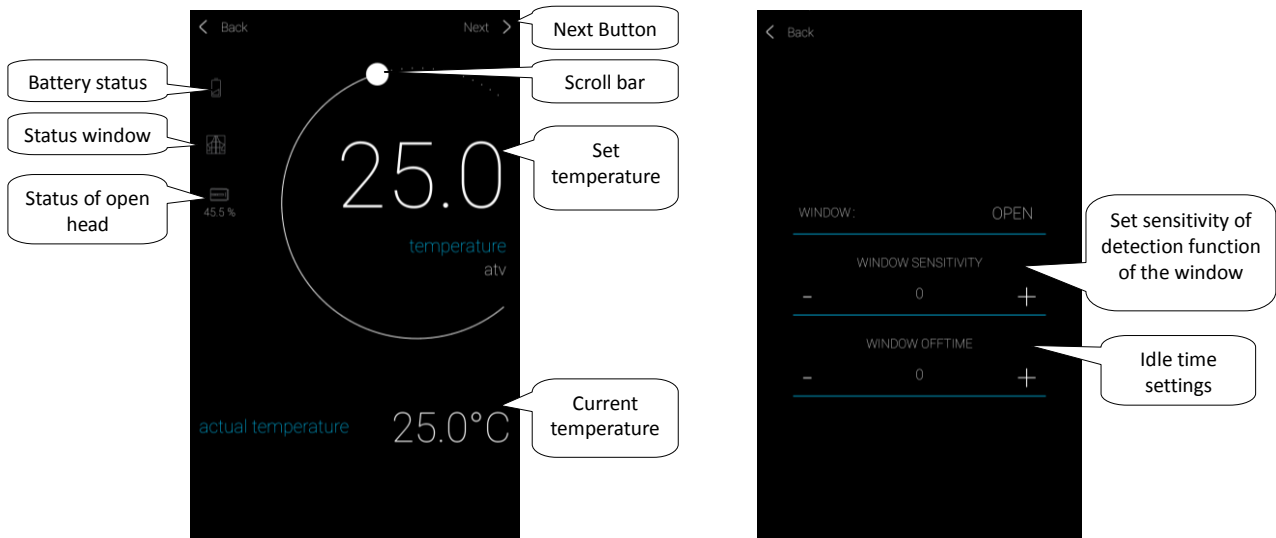

*Calibrating the RFATV-1:

1. open the battery cover
2. remove the batteries
3. after 30s, insert new batteries (observe the polarity)
4. close the battery cover
5. using a „key“, press the blue button. The therموالve itself will find the extreme position open and closed on its own. During calibration, do not touch the therموالve. A flashing green LED diode on the therموالve indicates the end of calibration.

• **Temperature control**

Heating circuits can be controlled right from the rooms in which they were assigned.

For heating circuits in the room, the following is displayed:

- Current heating mode to the given heating circuit.– indicates the color of the scroll bar
- Current temperature of sensor at the unit assigned to the heating circuit.
- Active heating or cooling - blinks with the current mode at the bottom of the icon.

• **Heating circuit**

Change the heating circuit-mode by long pressing open the circuit and according to requirement, you can:

- change the heating mode
- perform a manual adjustment of the temperature in the range of the set temperature mode
- switch on/off the entire circuit (regardless of its time plan)
- inform on current and set temperature
- Activate cooling

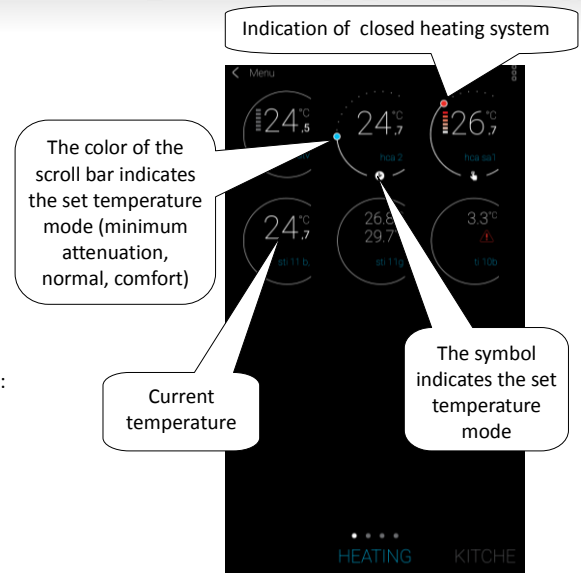

After manual adjustment of the heating mode, the heating circuit in the following set time interval returns, and will continue to work according to the set time plan.

You can manually adjust the temperature in the application at any time within the temperature mode. The adjusted temperature is only valid for the current time interval.

If the RFTC-10 / G, which is in eLAN mode, manually adjusts the temperature, it switches to Temporary Manual Mode.

By pressing ON/OFF , you switch on/off the entire heating circuit regardless of its time plan.

In the correction wheel, the Set temperatures are displayed.

Set temperature - set in the heating mode +/- temperature correction adjusted by user.

Current temperature – measured by temperature sensor of one of the connected units.

After a power failure, for safety reasons, the mode switches to default:

- Temporary mode (hourglass) switches to automatic
- Continuous manual mode (hand) does not change.
- Auto mode (clock) does not change.
- The holiday mode (case) does not change.

Description of the screen:

1. ON/OFF
2. Temporary manual settings (feature only applies to the next preset time schedule changes)
3. Manual settings (if it doesn't change, you switch to another mode)
4. Automatic control of the heating circuit according to the selected heating schedule
5. Holiday mode
6. Set temperature
7. Scroll bar for manual adjustment of the temperature
8. Current temperature
9. Set temperature mode (option)
10. Switching between heating and cooling
11. Advanced settings for thermostats

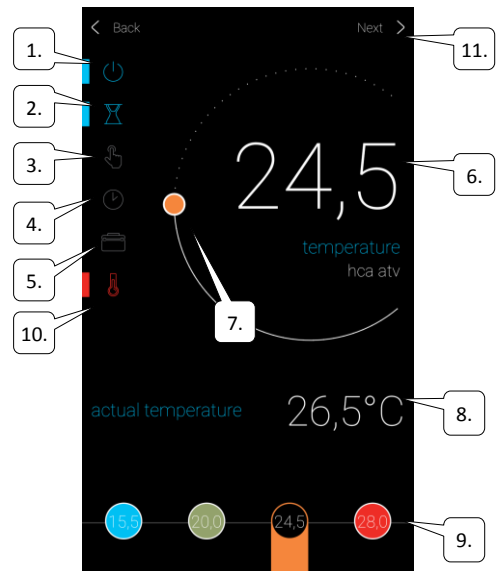

Thermo heating circuit:

By setting function in the *detection window* in the heating circuit every thermo-valve is reflected separately.

If thermo-valve head RFATV-1 is part of the heating circuit element for heating. The heating circuit can be controlled in two ways:

- According to the temperature measured thermo-valve head
- Using another thermal components

For thermostats in the heating system percentage or hysteresis control can be used.

Control of the heating circuit without a central source by means of the thermocouple RFATV -1:

This type of connection is mainly used in flats and apartment buildings connected to an external central source.

The type of regulation (percentage / hysteresis) does not affect the occurrence of any serious temperature deviations in this heating circuit.

Heat circuit offset setting:

- The **RFATV-1** temperature offset is performed only after it has been stabilized, i.e. within 2 days of installing and activating the **RFATV-1**.
- In the application, select the mode (e.g. Normal) and set the temperature.
- After about 3 hours of heating, measure the temperature at the point where the temperature is desired.
- Depending on the temperature difference, set the offset on the **RFATV-1** thermocouple.
Example: In the RFATV-1 application it displays a temperature of 28 ° C, a real temperature of 25 ° C is displayed on the thermometer, set offset -3 ° C for the RFATV-1.

Control of heating circuit with central source and thermostats RFATV -1:

- Use the percentage control if your central source (boiler) uses a continuous flow control (PID) of the heating water (TV).
- Use hysteresis control for heating systems where a central source (boiler) is available without any internal regulation of the heating water (TV), i.e. the central source (boiler) operates in the heating / non-heating mode.

Recommendation:

- If you want to use the **RFATV-1** heating control system in conjunction with central boiler control, it is recommended to use the RFTC-10 / G temperature controller for temperature measurement. In this case, calibrate the **RFATV-1** thermocouple with the RFTC-10 / G temperature controller.

Calibration RFTC-10 / G and RFATV-1

- On the RFTC-10 / G, check the temperature according to the temperature measured on the thermometer at the point where you want the set temperature. If necessary, set the RFTC-10 / G offset to match the real-time temperature.
- Select the mode (e.g. Normal) in the application and set the temperature.
- After about 3 hours of heating, measure the temperature at the point where the set temperature is desired and compare it with the temperature displayed on the RFTC-10 / G.
The difference between these temperatures corresponds to the offset you set to RFATV-1.
The temperature measured on the thermo-valve in this case is the standard, used primarily to offset adjustment for this type of connection.
- The heating circuit will display the temperature from the set RFTC-10 / G.
WARNING: For proper operation, we recommend that you perform the calibration 5 times (over 5 days). On the first day, the temperature difference will be greatest and the difference will be "fine-tuned" in the following days.

Percentage regulation:

The central source switches according to the set percent of the thermo-valve opening. The central source switches on if the thermostats is open to more than the set point and turns off until the thermostats is closed to less than the set percentage.

If the heater head is connected to the central source in the heating circuit, the central source of the fluids switches to at least one thermostats open at the set percentage and turns off until the last thermostats is closed to less than the set percentage.

Cannot be used for cooling.

Hysteresis regulation:

The central source switches on when the set point is lower than the actual one and switches off when the set point is higher than set - the central source does not wait for the percentage of the thermostats opening.

Hysteresis control can also be used for cooling.

When combining thermostats and switching actuators in the heating circuit, the thermostats behave according to the selected control, the switching components switch according to their own setting.

Safety precautions for heating circuits:

If communication is lost with the thermal component (e.g. insufficient signal) the temperature recorded in the ELAN remains for maximum of 17 minutes. After this time, the central source and the heating circuit that is controlled by this temperature are switched off.

If you lose power to eLAN:

- If the RFSTI-11B and RFSTI-11G components are included in the circuit - the circuits (components) are turned off within max. 30 minutes.
- If the RFSA-x components are part of the circuit, the circuits (components) are turned off within max. 10 minutes.
- If they are part of the thermo-couple circuit - and the set temperature is 21 ° C, the thermo-couple automatically sets to 21 ° C, if the set temperature is lower than 21 ° C, the thermo-couple is set to the last set temperature.

6.1.4. Display of energy measurements

By touching the time period displayed on the right of the screen, you will see all of the measured data found in RFPM-2 over a given time period. Currently, day, week, month, year or total consumption can be selected.

The first time you start it, it will start downloading data to the app - this may take a few minutes. This data is continuously updated and remains stored in the application.

The water column can be expanded by touch to the separate columns of hot and cold water consumption.

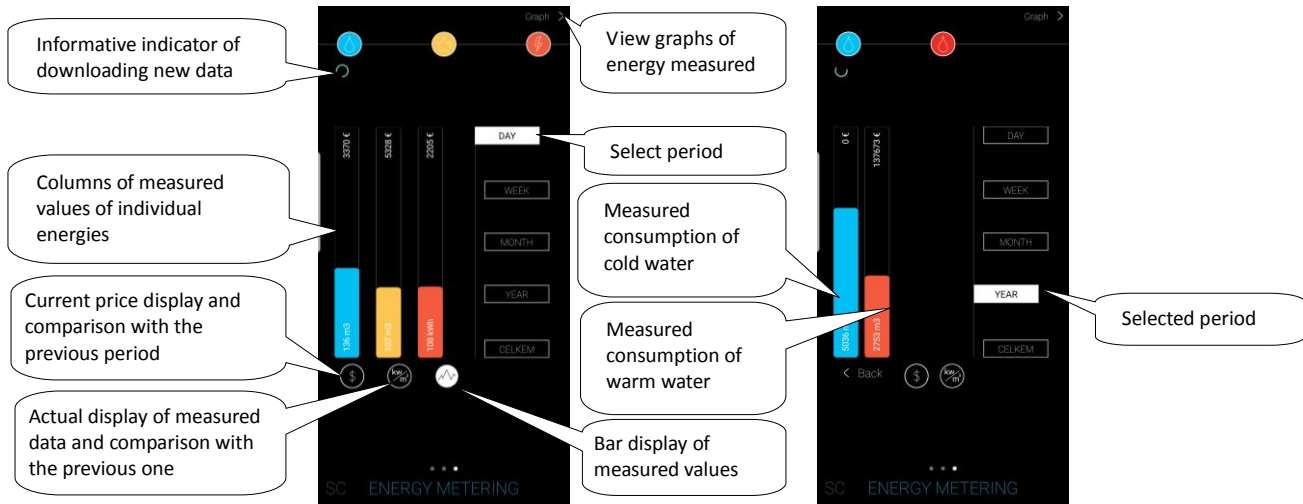

Fast display of measured data - you can choose from the measured energy or price display and their comparison with the previous period.

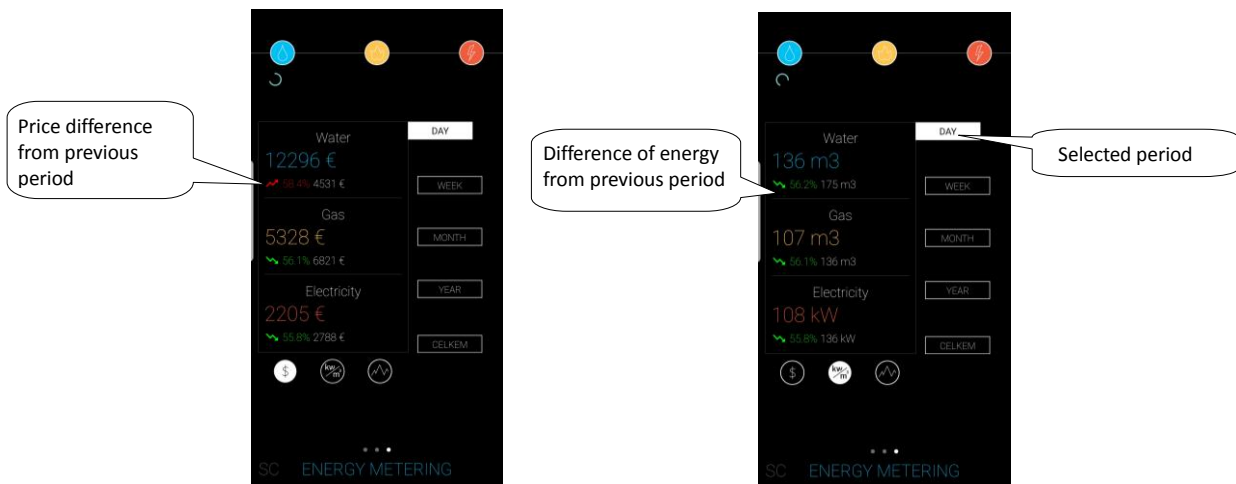

The column of electricity can be expanded by touching the columns of individual tariffs, the phases are displayed after touching.

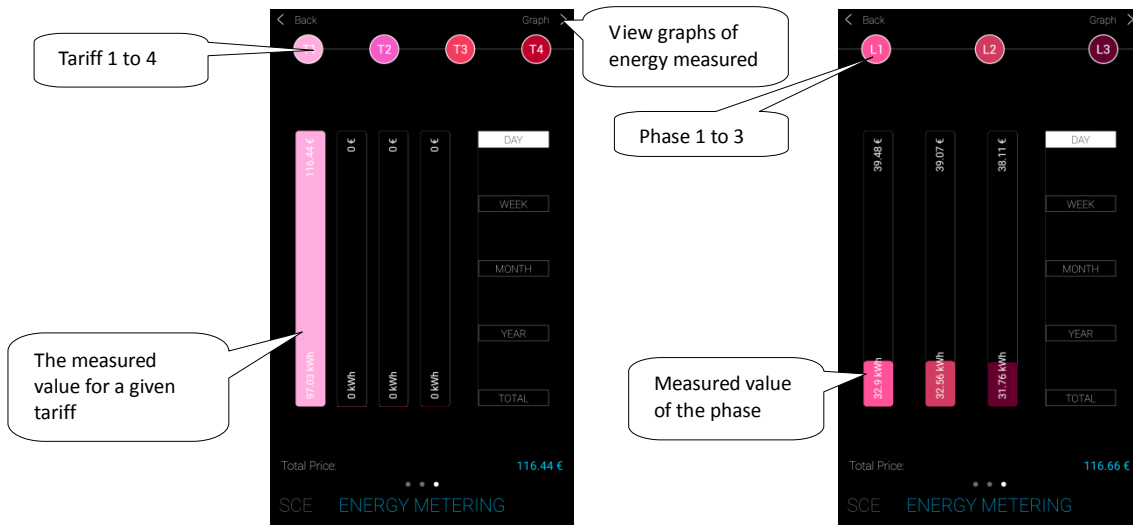

Touching the *Graph* button in the top-right corner displays graphs of the measured quantities.

Select the measured energy at the top of the screen.

At the bottom of the screen, you can switch between showing the price or energy consumed in the chart, depending on the selected time period.

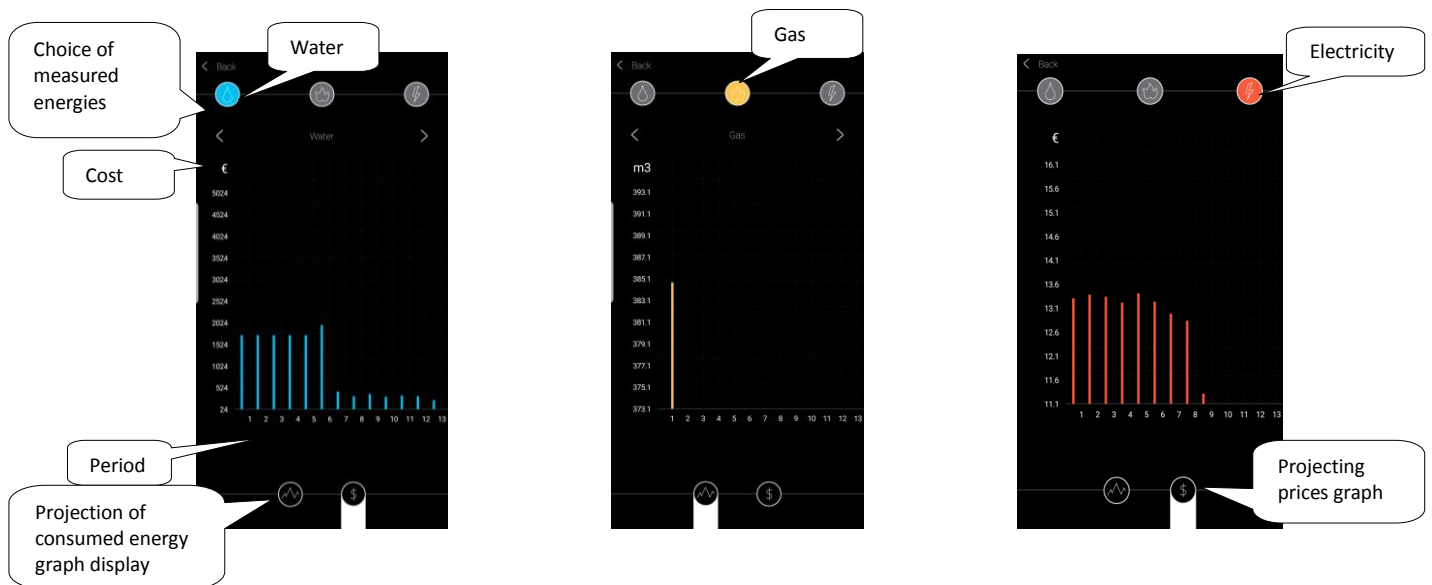

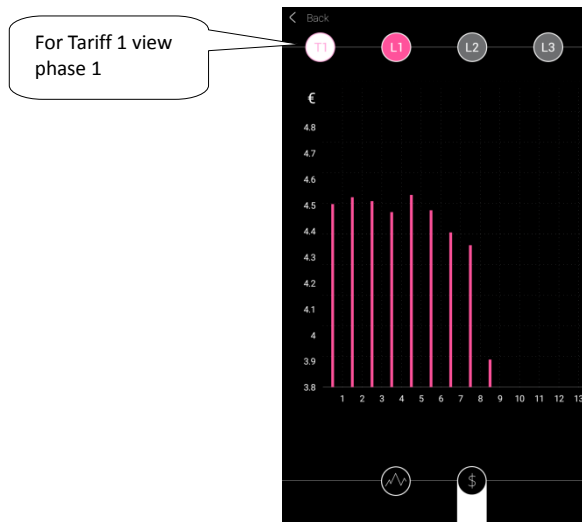
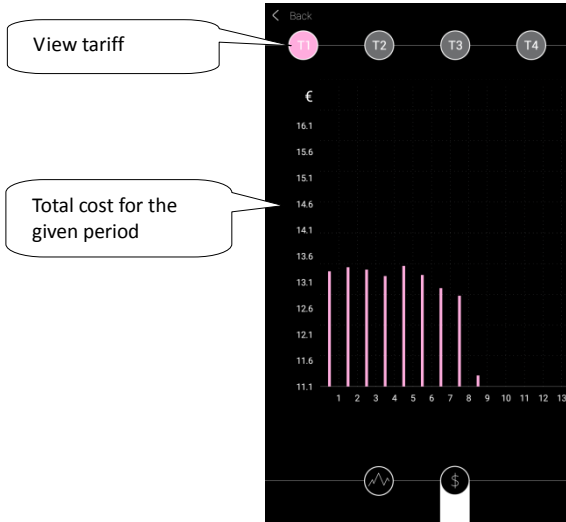

Touch *Back* to return to the measured energy screen.

6.2

Scenes

Press on the icon to start the Scenes action that you have assigned to the components of the set. The activated scene is pressed under blue colour.



6.3 Weather

In the Forecast shows the current status of the temperature, humidity, wind speed and pressure set up weather stations.

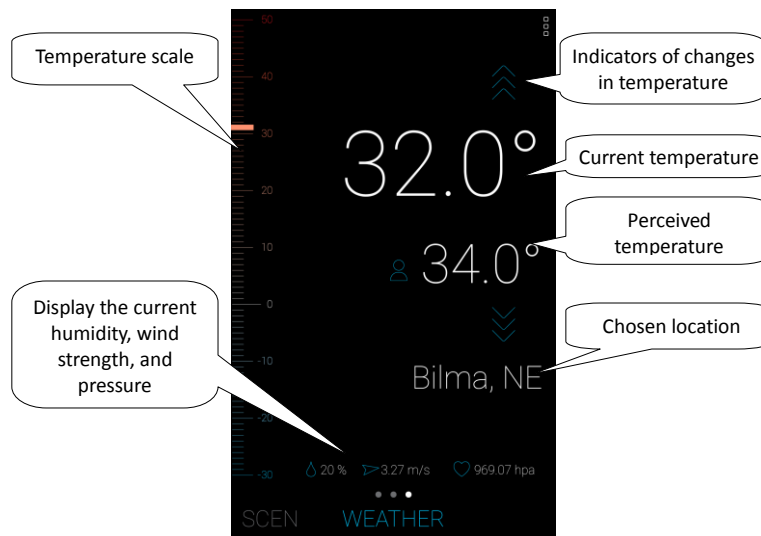

6.4 Cameras

In the Camera display Tabs set of cameras. The application allows full screen video camera display; press and hold the relevant video camera view to open the PTZ panel to control it (if the PTZ camera supports it).

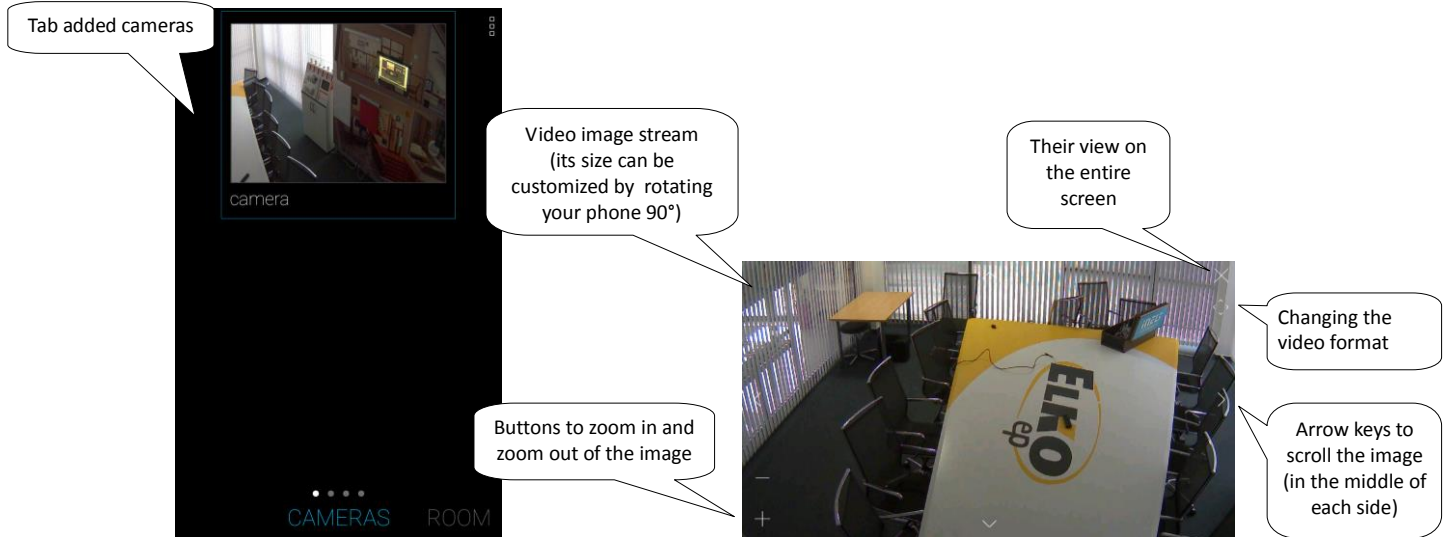

6.5 Intercom

In the Intercom is displayed a list of contacts. Touch the contact to activate the call.

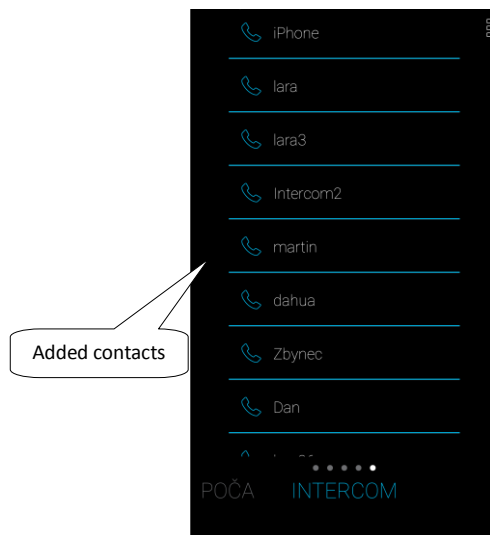

House Watch / iHC contact:

Answer the call – touch the Green handset
End the call - touch-the Red handset

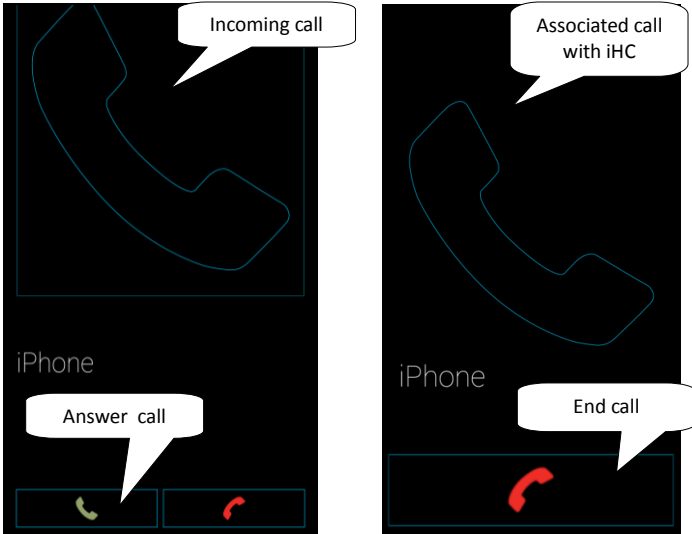

House Watch with a camera:

Answer the call – touch the Green handset
End the call - touch-the Red handset

